



# Essential Skills - Communication Level 2 for Construction Students

**ES LEVEL 2 RESOURCE FOR CONSTRUCTION STUDENTS - AUGUST 2010**



## **Essential Skills Communication for Construction Students**

Essential Skills Communication Level 2 is an equivalent to GCSE band A-C. It is accepted by Queen's University and The University of Ulster.

At Level 2 you will do a project (Action-based Activity) on a subject you are interested in and will take an exam (Desk Top Task) at the end of your course.

This resource will help you with the skills you will need to achieve your Level 2 in Communication.

Action-based Activity (Portfolio) guidance and an example portfolio is included.

Good Luck!

### **Acknowledgements**

CITB-ConstructionSkills Northern Ireland who had this resource published. Mark Byrne. Alex Moorehead, Caylan Ellesmere, David Burleigh, Ivor Caldwell, Roger McKee of South Eastern Regional College, Lisburn Campus, Dept for Built Environment, for their information and advice on construction issues. Linda Duffy, Maire McAnespie. Annette Dixon – Essential Skills for ABA Guidance. Muriel Tafts marketing. Martin Curran and Adam Curran for photographs used in this publication.

### **Aims**

It is intended that these vocationally contextualised resources will support Essential Skills Literacy tutors in their efforts to make programmes for construction students vocationally relevant. This resource should be used in the context of appropriately planned and structured Essential Skills programmes and should be used and adapted appropriately within that context.

### **Guidance for Using Resource**

It is not intended that these materials should be used as a fixed programme of learning but as a resource which tutors can use to aid them in the planning and delivery of programmes suited to the needs of their particular groups of learners. It is envisaged that tutors will bring their own ideas to these materials and extend and enhance them in order to keep activities refreshed and dynamic for their learners.

Essential Skills tutors should ensure that they read and understand the following DELNI publication before they develop programmes: ESSENTIAL SKILLS GOOD PRACTICE: THE ASSESSMENT PROCESS. DEL NI, July 2007. Available from **[www.essentialskillsni.com/articles](http://www.essentialskillsni.com/articles)**

All information in this resource is current and up to date at the time of printing (September 2010)

Author: Anne Curran  
South Eastern Regional College

### **Disclaimer**

The contents of this resource are fictional. No actual person, company, or event, is depicted.

# CONTENTS

## READING

TASK NUMBER	PAGE NUMBER
1 TEXTS - PRESENTATIONAL FEATURES	7
2 READING AND SELECTING RELEVANT INFORMATION - SUMMARISING	19
3 SUMMARISING	24
4 FORMAL AND INFORMAL TEXTS	25
5 READING AND UNDERSTANDING - SKIMMING, SCANNING & DETAILED READING	26
6 TYPES OF TEXTS - LINGUISTIC FEATURES	31
7 TYPES OF TEXTS - WRITING TO INSTRUCT	36-38
8 TYPES OF TEXTS - PERSUASIVE WRITING	39-43
9 ANALYSING A NEWSPAPER ARTICLE	44-47
10 READING IMAGES	48-50
11 PRACTICE FOR DESK TOP TASK - PART 1	51
Answer Section	56-70

## WRITING

TASK NUMBER	PAGE NUMBER
1 SENTENCES	72-79
2 SIMPLE, COMPOUND AND COMPLEX SENTENCES	80-81
3 PUNCTUATION	82-96
4 APOSTROPHES	97-105
5 SUBJECT VERB AGREEMENT	106-107
6 VERB TENSES	108
7 SPELLING HOMOPHONES	109-117
8 PARAGRAPHS	118-126
9 MIND MAPPING	127-128
10 STRUCTURING AN EXTENDED TEXT - RISK ASSESSMENT REPORT - EXCAVATION	129-130
11 PROOF READING AND REVISE WRITING FOR ACCURACY AND MEANING	131
12 WRITING AN EXTENDED TEXT - REPORT ON COMPANY	132
13 WRITING AN ESSAY / ARTICLE	133-140
14 FORMAL LETTER – LETTER OF COMPLAINT	141-147
Answer Section	148-162

## **SPEAKING AND LISTENING**

<b>TASK NUMBER</b>		<b>PAGE NUMBER</b>
1	SELECTING MAIN POINTS FOR A PURPOSE	165
2	DISCUSSION - PAIRS - CAREER PATH	166-167
3	GROUP DISCUSSION	168-171
4	RATE YOUR PERFORMANCE - GROUP DISCUSSION CHECKLIST	172
5	ONE MINUTE TALKS	173
6	RATE PRESENTATION PERFORMANCE - CHECKLIST	174
7	TOOL BOX TALKS - HEALTH & SAFETY	175
8	PRESENTATION - APPRENTICES IN THE DRAGON'S DEN	176-178
	Answer Section	179

## **ACTION BASED ACTIVITY GUIDANCE**

	<b>PAGE NUMBER</b>
IDEAS FOR ACTION-BASED ACTIVITIES	181-182
RESEARCHING INFORMATION USING ICT	183-185
ESSENTIAL SKILLS ACTION-BASED ACTIVITY L2 GUIDANCE	186
MAKING NOTES	187

## **SAMPLE PORTFOLIO ACTION-BASED ACTIVITIES LEVEL 2**

<b>PAGE NUMBER</b>
188-216

## **REFERENCES**

	<b>PAGE NUMBER</b>
USEFUL BOOKS AND WEBSITES	218



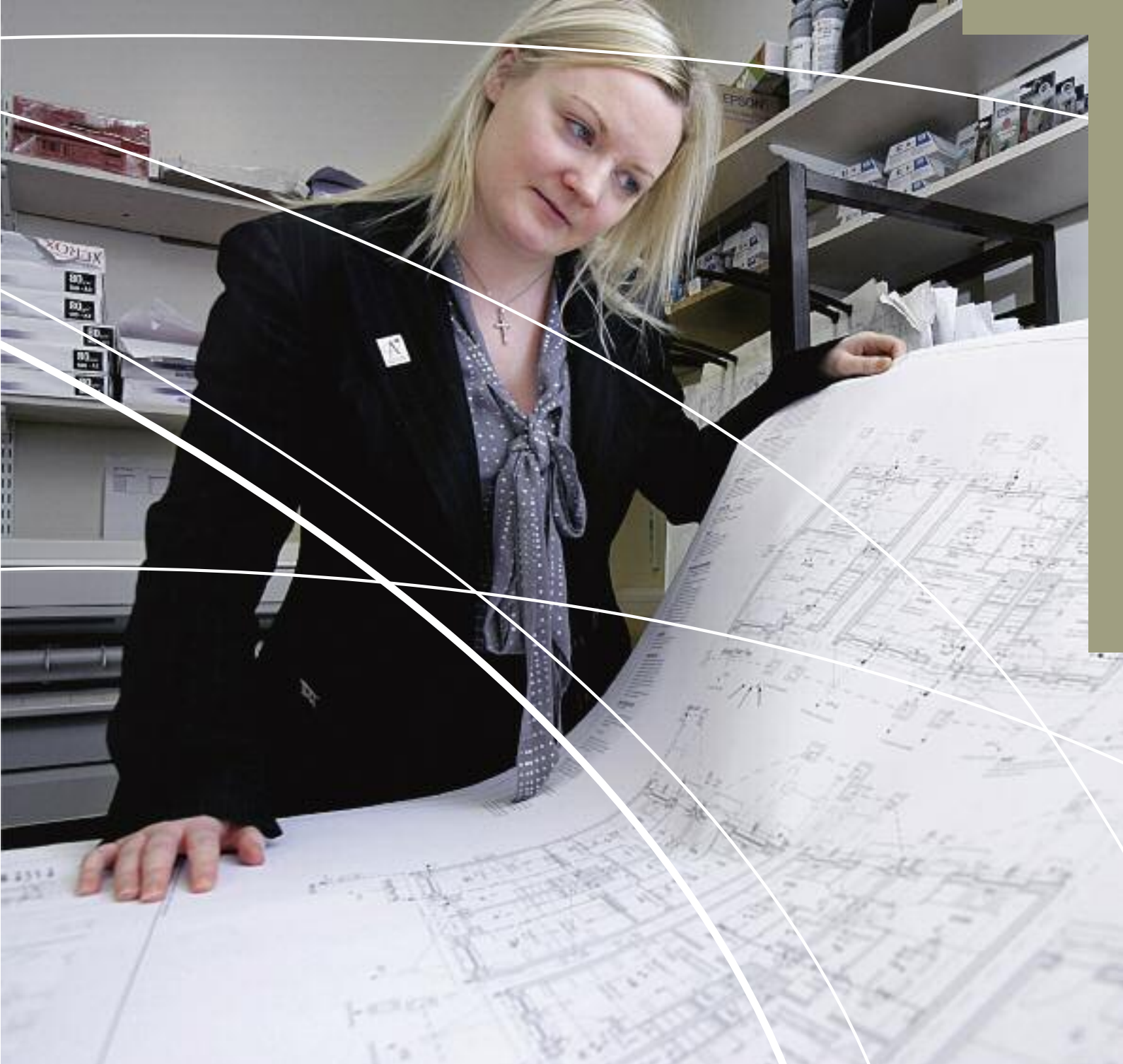

# READING Tasks and Answers



# READING TASK 1

## TEXTS - PRESENTATIONAL FEATURES

There are many different types of texts. A text may be written to inform, instruct, describe or persuade. Texts are presented in different ways.

### Types of Texts

Adverts	Newspapers
Newspaper Article	Letters
Phone text.	Notes
Stories	Lists

### How Texts are Presented

Texts are presented in different ways:

#### Letters

Dear Mr Smith

I am writing in reply to your advertisement for a bench joiner, in today's Belfast Telegraph.  
I have just finished my apprenticeship and I am a fully qualified bench joiner specialising in kitchen and office fitting.

#### Adverts



#### Flights

Snap up cheap flights to worldwide destinations with your favourite airlines.

**Flights from £91pp**

# READING TASK 1

## Newspapers

**Broadsheet**



**Tabloid**



## Notes

### Tools for Building Shed

- Wood preserver – buy (offer at B & Q – call on Thursday after work)
- Wood drill bit set
- Claw hammer – lent to Joe – text him.
- Step ladder – pick up from Chris
- Tape measure
- Stanley knife
- Rubber gloves and goggles
- Driver drill bit set
- Cordless power drill
- Round nails
- Sealant gun
- Varnish brush
- Spirit level

## Phone Texts

Gr8 jb m8 ta



# READING TASK 1

## Business Cards



**William Foster**

**Building  
& Joinery**

**Contact William**

**Telephone: 02891787137**

**Mobile: 07877756910**

**[www.wfosterbuilding.co.uk](http://www.wfosterbuilding.co.uk)**

- **Extensions**
- **Sunrooms**
- **Conservatories**
- **Garages**
- **New Builds**
- **Conversions**

**COMMERCIAL / PRIVATE**

**[www.wfosterbuilding.co.uk](http://www.wfosterbuilding.co.uk)**

# READING TASK 1

**PRESENTATIONAL DEVICES** are sometimes used to present information and ideas. They are written this way to have a particular effect on the reader.

## Features of Presentational Devices

FEATURE	USE
Heading	To indicate main topic
Subheadings	Show new aspect of topic
Photographs	Illustrate aspects of the text by showing them in a visual way.
Diagrams and graphs	Bring information together in a more visual way.
Use of colour	Colour is attractive. Can be used to separate out certain aspects of text. Can also be used to indicate a mood e.g. the colour red is traditionally associated with danger.
Different print size	To separate out different information and to emphasise parts of text
Different types of font	To separate out different information
Bold print	To emphasise something
Bullet points	To list items or ideas within a text.
Numbering	To show order of ideas or information e.g. in written instructions.
Italics	To emphasise something.
Underlining	To emphasise something
Logo	Logos are a company brand and reassure customers they are receiving best advice, service, product etc.

# READING TASK 1

Read the leaflet on how to lay a patio and see how many of the following presentational features the writer has used.

PRESENTATIONAL FEATURE	FEATURE IN LEAFLET.	PRESENTATIONAL FEATURE	FEATURE IN LEAFLET
Heading	✓	Graphs	
Subheadings		Logo	
Diagrams		Bold print	
Use of colour		Italics	
Different size print		Bullet points	
Different font types		Underlining	
Unusual use of capital or lowercase letters		Numbering	
Photographs			

Now write a sentence or two on the presentation of the leaflet.

## 1. How colour is being used.

## 2. The effect of heading and subheadings.

# READING TASK 1

**3. Why numbering and bullet points are used.**

**4. Is different print size or bold print being used? What for?**

**5. This is one of Homebase's 'How to...' leaflets. Why is the company's logo important to the text?**

**6. Why are photographs and diagrams being used – rather than just more words?**

# how to...

## lay a patio

A brief guide. Skill rating: intermediate

**In this guide we show you how to plan your patio, prepare the ground and lay the paving. This is a fairly simple DIY task but paving can be heavy, so you may need some help. Depending on the patio size, the project could take you 2 to 3 days.**

### 1: Planning for your patio

- Once you've decided where you want your patio, draw a detailed plan to scale using graph paper, including the dimensions of the patio area.
- Mark on the plan all permanent fixtures e.g. the house, walls, fencing, manhole covers (which must be paved around and can affect the level of the patio), as well as trees or large plants.
- To avoid having to cut slabs, a 'chessboard' layout or one of the range of stones that features half-slabs are good choices.
- Staggering paving (like a brickwork finish), or laying a random pattern of different sized slabs, usually means that you'll end up having to cut slabs to get a straight border - seek advice before cutting slabs.
- The surface of your patio must be at least 150mm below the damp-proof course of the house so that rain doesn't bounce off and hit the wall above.
- Your patio must have a gradual slope away from the house to ensure all water drains off. Allow about 25mm drop in every 1.5m (**fig. 1**) or alternatively install a drainage channel.
- Allow 10mm – 30mm between slabs for fettled edge, natural stone or heavily riven slabs, and 10mm – 15mm for straight edge slabs.

**Gardening**

**HOME**BASE



## 2: Measuring up

- Calculate the area of your patio in square metres. Each pack of paving slabs shows the area it covers. If you are using a single size slab, divide the area of your patio by the area covered by one pack to see how many packs you need to buy.
- If you are using different size slabs the calculation is more complicated and you should ask for advice.

## 3: Marking out the patio

- Accurately transfer your plan to the ground using wooden pegs, a builder's square and string.
- Mark lines on the wooden pegs to indicate the depth of working i.e. the finished level of your hardcore, bedding mortar and the surface of the patio slabs.
- You need to make sure the marks for the top surface are level with any existing paving and manhole covers (fig 2).
- Remember to allow for a gradual slope away from the house when inserting your wooden pegs (fig. 1).

## 4: Preparing the base

- Remove any turf, plants or paving and dig down to a depth of about 150mm to allow for the foundations.
- To lay a solid base for your paving slabs, you first need a layer of hardcore to a depth of about 50mm to 80mm (fig. 3) over the area of your patio.
- Use a rake to distribute the hardcore, evening out any bumps. You could hire a powered wacker plate to compress the hardcore to give a good solid base.
- Add a layer of bedding mortar over the compacted hardcore (fig. 3).

## 5: Preparing the bedding mortar

- Mix the bedding mortar on a plastic sheet.
- A ratio of 3 shovels of building sand to 1 shovel of soft sand to 1 shovel of cement is about the right mix. Add water sparingly to the centre of the mix and turn it over to create a wet mix.

### helpful hint...

Paving slabs should always be bought at the same time to avoid variations in colour and texture.

## how to...

## lay a patio



▲ (fig. 1) You must allow for a slope on the patio to make sure water drains away from your house. Allow a 25mm drop for every 1,500mm of patio.

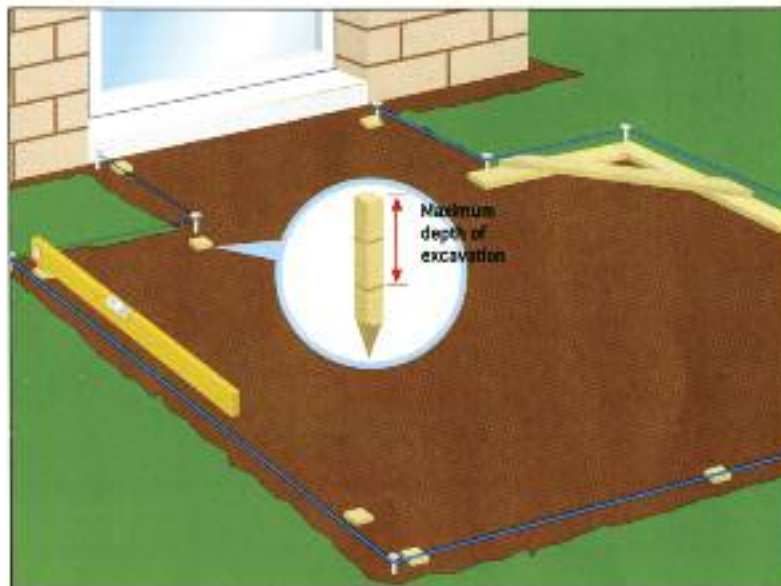

▲ (fig. 2) Lines can be drawn on the pegs to indicate the depth for working.



▲ (fig. 3) Compacted hardcore flattened with a powered wacker plate forms the solid, flat sub-base necessary for the bedding mortar and paving. NOTE: the layers on this diagram are not to scale.

**how to...**

**lay a patio**

**Tools for the job...**



▲ Spirit level



▲ Cement



▲ Hosepipe



▲ Builders square



▲ Bucket



▲ Club hammer



▲ Spade



▲ Sponge



▲ Wheelbarrow



▲ String



▲ Screeding float



▲ Pointing trowel



HEHOWD20 March 2009





▲ (fig. 4) Before the first slab is laid, check the string guidelines are square to the house using the builder's square.



▲ (fig. 5) The slab can be gently tapped until they are the correct level.

- Put down enough mortar (to the required thickness, 25mm – 45mm) so you can lay down one complete line of slabs. Make sure you compact the mortar and level it using a wooden or plastic screeding float trowel.
- Make sure the thickness is even over the ground.

## 6: Laying down the paving slabs

- Before you lay down any slabs, check with a builder's square that the string guidelines are square to the house (fig. 4), if not adjust the guidelines until they are.
- Lay down the first slab against the house at the corner, checking its alignment with the string guideline. It's important that the first slab is positioned accurately.
- Gently tap the slab to the correct level (fig. 5), using a club hammer and block of wood to protect the slab.
- Lastly, check the alignment of the slab with the spirit level, allowing for the slope away from the house.
- Continue until all the paving slabs are laid down and do a final check to make sure they are all level.

## 7: Pointing (filling the gaps between the slabs)

- Once you have laid down all your slabs, leave the mortar to dry for at least 24 hours before filling or 'pointing' the gaps between the slabs. This mortar stops your slabs moving and prevents weeds from growing in the gaps.

more how to leaflets available at [homebase.co.uk](http://homebase.co.uk)

- To make up mortar, use a semi-dry mixture consisting of 4 parts building sand to 1 part cement.
- Make sure the mortar is only just wet to prevent shrinkage.
- Test the mortar by taking a handful and squeezing it. It should stay as a firm wet ball when you open your fingers and not crumble (too dry) or ooze water (too wet). To adjust the consistency, add water if it's too dry or more sand and cement (pre-mixed to the correct ratio) if too wet.
- Press the mortar into the gaps with the edge of a trowel.
- Brush off any surplus mortar before it's completely dry using a semi-stiff brush. Finally, wash the slabs with a damp sponge and clean water to remove all traces of cement.

## 8: Letting the mortar dry out

- If you are laying your patio in the summer, make sure the mortar doesn't dry out too quickly as it could crumble.
- Equally, in colder weather, protect the drying mortar from rain or frost with polythene sheeting.
- It will be 24 hours or longer before your patio can be used, to allow it to dry properly.

## 9: Maintaining your patio

- If you want to seal the patio to prevent water seepage or fading, check the manufacturers' recommendations. Applying a sealant to paving may affect the colour.
- If the patio freezes, using salt could damage the surface. Use a plastic shovel or stiff brush to remove snow and ice.
- Every three months it's worth checking for loose or damaged slabs and making sure that all the pointing is in tact.
- Look for any stains such as alcohol, barbeque fat, chewing gum or bird droppings and give these an intensive cleaning treatment, always following the manufacturer's instructions.

## helpful hint...

Have you got a pressure washer? Use it on a low setting for cleaning your patio, making sure you point it at an angle facing away from the slabs.

Be careful not to use it too hard or too close to the slabs or you'll damage the surface of your paving.



# READING TASK 2

## READING AND SELECTING RELEVANT INFORMATION - SUMMARISING

You will often need to select the relevant points from either written or spoken information and summarise it for the reader or listener.

When working on your project you will need to read and summarise two texts of 500 words or more.

### What is Summarising?

A summary is a shorter description of a longer text or speech, which should be easy to read and to understand. It contains all the relevant details of the original text/speech but includes none of the facts, opinions or descriptions that are not relevant to the overall meaning of the original information.

For example, when filling in an application form or preparing a CV (Curriculum Vitae) for a job, you would include only the information that is relevant to the job application. A CV is only one or two pages long and the information you provide is a summary of your educational and work history, achievements and experience. It will allow an employer to judge if you have the necessary qualifications, training and skills for the job.

(Think about the difference between a CV - education and employment history - and an autobiography - your life story - where you can write about all the various aspects of your life).

### Do's and Don'ts of Summarising a Text

#### Do

- Quickly skim read the original text to get the overall meaning. The title and subheadings can provide clues.
- Reread the text again thoroughly to make sure that you understand its overall meaning.
- Look out for hidden meanings (positive / negative vocabulary etc).
- Find out the meaning of any unfamiliar words.
- Highlight or underline the main points of the text, leaving out any irrelevant information (details, descriptions or opinions)
- It is helpful to bullet point these main points in order to make it easier to write your summary in its proper sequence.
- Summarise by bringing the key points together in sentences and paragraphs, using proper punctuation and grammar.
- Write summary in your own words (technical terms can be taken from the original text but do not copy out sentences or paragraphs).

# READING TASK 2

- Include information provided by images if relevant to the overall meaning.
- Change direct speech into reported speech, e.g. “Sammy Wilson says, ‘I still think man-made climate change is a con” would be changed to e.g. Sammy Wilson thinks we are not responsible for climate change.
- Keep summary brief and easier to read than the original.
- READ OVER YOUR DRAFT TO MAKE SURE YOU HAVE CAPTURED THE OVERALL MEANING OF THE ORIGINAL TEXT.
- ACKNOWLEDGE YOUR SOURCE / S. At the beginning or end of your summary give details of the original text e.g. Source, title, author and date

## Don't

- Do not include any unnecessary detail that does not support the overall meaning of the text. For example, when writing a report on a workplace accident, you would not include what the weather was like that day unless it directly related to the cause of the accident e.g. slip caused by frost or ice.
- Don't just jot down rough notes – that is not a completed summary.
- Never just copy chunks from an original text.
- Include information descriptions or opinions that do not support the overall meaning of the text.
- DON'T FORGET TO READ OVER YOUR DRAFT TO MAKE SURE YOU HAVE CAPTURED THE OVERALL MEANING OF THE ORIGINAL TEXT.
- DON'T FORGET TO ACKNOWLEDGE YOUR SOURCE / S

At the beginning or end of your summary give details of the original text e.g.

**Source:**

**Title:**

**Author:**

**Date:**

# READING TASK 2

## Example

**STEP 1. Below is an original text. The main points have been highlighted in yellow.**

### Energy Conservation

When we use **energy** in factories or to heat our homes we **contribute to** the amount of **greenhouse gasses** that are released into the atmosphere.

When greenhouse gasses are released into the atmosphere they **cause global warming and climate change**. The **government wants us to reduce the amount of energy we use** in our homes and factories. The government, through the Building Regulations, has now **issued guidelines** to reduce the amount of energy used. The government wants us to **increase** the amount of **insulation** within the walls of **homes and factories**. Walls are made up of mainly of masonry, timber and glass.

102 words

## Example

**STEP 2. These are the main points selected from the original text and listed in bullet points.**

### Main Points of Article

- The energy we use causes global warming.
- The government has produced guidelines on reducing energy.
- The government wants an increase in wall insulation in homes and factories.

**STEP 3. Here is the final summary. I have rewritten it in my own words. It is written in full sentences and I have left out any unnecessary detail.**

### Summary

The government wants to reduce the amount of energy used to heat homes and factories in order to reduce the amount of greenhouse emissions causing global warming. They have issued guidelines that homes need to be better insulated in order to reduce greenhouse emissions.

44 Words

# READING TASK 2

## ACTIVITY

Now try this one

### 1. Building a Shed

When you buy the materials to build your shed make sure you have everything you need for the job. There is nothing worse than being in the middle of a job and having to down tools and go to the building suppliers (if they're open) to buy things like screws, nails and so on, especially when you thought they were to hand in the first place.

66 words

#### Main Point/s of Text

(in bullet points)

#### Summary of Text

\_\_\_\_\_  
**Words**

# READING TASK 2

## ACTIVITY

**2. Now read and summarise the article 'Design methods that take account of renewable energy resources.' (Page 29)**

**Main Point/s of Text**  
(in bullet points)

**Source:** CITB-ConstructionSkills Northern Ireland

**Title:** Design methods that take account of renewable energy sources.'

**Author:** A Reporter

**Date:** 26.05.10



# READING TASK 3

## SUMMARISING

### Factors that Influence the Design Decision

You are writing an assignment on factors that influence design decisions. Summarise the following information selecting only the information that is relevant to your **purpose, context** and **audience**.

#### **Air Quality**

Air quality needs to be considered as poorer quality of air can cause health and breathing difficulties in the long term as well as some short term effects. This is important because I know from first hand the problems of poor air quality. My grandmother had asthma and my sister takes after her - not just in looks - she has asthma too and has been to hospital three or four times. Also if a company's emissions are to be the cause of the problem the company can be liable to legal action. So less harmful emissions in the air is better all round for the company, environment and the general public.

#### **Ozone Layer**

The ozone layer has also to be considered as greenhouse gasses such as CO<sub>2</sub> and CFC's are causing a harmful affect on it and the ozone layer is letting in some of the sun's harmful UV rays. Also heat is being trapped on top of this. I don't know what all the fuss is about to be honest. We could do with a bit more sun and heat in Ireland. Areas being affected by this are Antarctica and Southern Chile because there is a hole in the ozone layer. The harmful greenhouse gases are causing global warming which affects everyone.

#### **Landscape / Preservation Orders**

Landscape also influences the design decision as the landscape of the area you may plan to build a project on may have preservation orders on them. I once lived in a house which had a preservation order on it. It was over two hundred years old with thick walls and a narrow driveway which was built for horses and not for cars. Preservation orders must be considered before and during the construction project.

# READING TASK 4

## FORMAL AND INFORMAL TEXTS

Using formal or informal language depends on the audience and purpose of a text.

### Formal style is usually used for:

- Official correspondence e.g. letters to or from your company.
- Official documents and books that have been published.
- Corresponding with people you are not familiar with.

### Informal style is normally used for:

- Speaking or writing to people we know well.

### Say which of the following features is formal or informal.

Feature	
Incomplete sentences	
Complex sentences	
No contractions	
Slang	
Short simple sentences	
Easy words	
Abbreviations e.g. gr8	

### Would the following be written in a formal or informal style?

Letter of application	
An internal company memo	
Email invitation to 18th birthday party	
Letter of opinion to local newspaper	
A mobile phone text to a friend	
A holiday postcard	
A post it to a family member	
A company report	

# READING TASK 5

## READING AND UNDERSTANDING - SKIMMING, SCANNING & DETAILED READING

### **Skimming, Scanning and Detailed Reading**

We skim read, scan read or read a text in detail depending on the information we want from the text. This makes for efficient research. Often we need to use all three skills in order to make sense of a text.

#### **Skim Reading**

Skim reading a text is where you would read over the whole text quickly to get a general idea of what it is about. For example, you might skim read a newspaper article or a story in a magazine in order to get the gist of the story.

#### **Scanning**

Scanning a text is where you would look over a text to find specific information. For example, we scan the yellow pages to find a decorator or a plumber. We would also scan dictionaries, glossaries, calendars and so on to find specific information.

#### **Detailed Reading**

Often when we read it is important that we read every word. For example, when we read a set of instructions it is important to make sure we do not leave anything out.

# READING TASK 5

## SKIMMING, SCANNING AND DETAILED READING

### ACTIVITY

- 1. Skim read the text below and, in just one or two sentences, say what the article is mainly about.**

- 2. Scan the text to find and list the sources of renewable energies discussed.**

# READING TASK 5

Read the text in detail to answer the following questions. Please give your answers in complete sentences.

**3. What are renewable energies?**

**4. Why are renewable energies now favoured over fossil fuels?**

**5. How is biomass produced and what is it used for?**

**6. How does Brundtland define 'sustainability?'**

# READING TASK 5

## **CITB-ConstructionSkills Northern Ireland**

### **Design Methods that Take Account of Renewable Energy Resources**

**By A Reporter**

**26th May 2010**

Building regulations and design methods must take account of renewable energy resources. Energy is essential to almost everything we do, from heating our homes to sustaining industry. We have come to rely on it in almost every aspect of our lives. Fossil fuels (oil, coal and gas) are used to create reasonably affordable energy but, unfortunately, the burning of fossil fuels releases vast amounts of carbon dioxide (CO<sub>2</sub>) into the Earth's atmosphere creating global warming. Fossil fuels are also not sustainable. They will eventually run out.

Brundtland (Brundtland Commission 1983) defined sustainability as "Meeting the needs of the present without compromising the ability of future generations to meet theirs."

To ensure energy sources were available to future generations, sustainable sources needed to be employed, and in 2003 the Energy White Paper outlined a long term strategic vision for energy policy. It looked at environmental issues, social targets, competitiveness and security of supply.

The Energy White Paper promotes the take up of renewable sources. It commits the United Kingdom to reducing emissions of greenhouse gasses by 60% by the year 2050. As 46% of carbon emissions relate to building occupation the EU has issued a directive on energy rating for buildings and regional building regulations have been revised.

There is now a shift towards energy sources and generation technologies that produce much less or even no carbon. Renewable energy is created from resources that occur naturally in the environment. These resources also occur repeatedly and so are renewed or replaced over a short period of time.

### **Types of Renewable Energy**

Sunlight, Wind, Water, Sustainable Biomass, Waves, Tides and Geothermal sources are natural processes that can be replenished over a relatively short period of time and are seen as inexhaustible

### **Wind Energy**

This picture shows the wind turbine at Antrim Area Hospital. In the first year in which it was installed this generating plant saved the Hospital approximately £100 000 from its electricity costs. This was about one fifth of the cost which was required to install the turbine.



# READING TASK 5

## Geothermal Ground Pumps

Ground source heat pumps are one of the most common types of heat pumps. Typically a cold fluid at about 5 degrees Celsius is circulated around a network of plastic pipes buried in the ground. As the fluid passes through the pipe it absorbs heat energy from the surrounding earth. The fluid returns to the heat pump slightly warmer than it left. The heat pump upgrades the heat to a higher level of 40 to 50 degrees Celsius to provide heating in the home. This water can then be circulated round radiators, under floor heating pipes or provide domestic hot water.

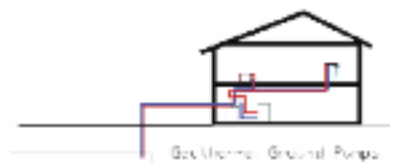

## Solar Energy

Energy from the Sun can be harnessed to generate Electricity or heat water. This photograph below shows the large solar panels on the roof of the ECOS centre Ballymena. The energy from these panels is used in the office building.



## Biomass

Biomass is the harvesting of willow trees to supply fuel for central heating using a specially adapted burner. The willow is grown in short-rotation crop and is harvested every two to three years with a specially adapted harvester. It can then be burned directly or made into pellets which are more efficient

This type of willow crop can be seen growing at the ECOS centre Ballymena



# READING TASK 6

## TYPES OF TEXTS - LINGUISTIC FEATURES

The type of text that is written depends on who it is being written for (the audience) and why the text has been written (the purpose). You will need to become familiar with the features of different types of text.

TYPES OF TEXT	FEATURES	
<b>Information</b> e.g. Newspaper Article - Leaflet	<b>Texts that provide information aim to be easy to read.</b> <b>They may have:</b>  <b>Headings and subheadings</b> - to show clearly the topic and aspect of a topic in the paragraph <b>Paragraph length</b> - shorter paragraphs make the text easier to read <b>Bullet points</b> - show what the main points are <b>Underlining</b> - to highlight important information <b>Bold print</b> - catches the attention of the reader. Used for headings and key words/phrases <b>Font Size</b> - larger font size indicates more important information <b>Italics</b> - to emphasize a point <b>Colour</b> - catches attention of the reader. It also shows difference.	
<b>Instruction Leaflet</b>	The writer <b>speaks directly</b> to the reader Instructions are in the <b>proper order</b> - often numbered. Written in the <b>present tense</b> Writer uses <b>words that give orders</b> - do / do not	
<b>Descriptive text</b> (e.g. stories, adverts)	<b>Aim:</b> Texts that describe aim for you to imagine what they are describing. They use:  <b>Adjectives</b> - used to describe nouns, e.g. 'The <b>views</b> from the holiday apartment were <b>stunning</b> .'	<b>Noun - views</b>
<b>Verb - lashed</b>	<b>Adverbs</b> - used to describe verbs e.g. 'The waves <b>lashed</b> <b>furiously</b> against the rocks.'	<b>'stunning' - adjective - describes the views</b>
<b>comparison with moon</b>	<b>Comparisons</b> - something is like something else e.g. 'The moon was like a <b>huge silver ball</b> in the sky,'	
<b>sense of touch - 'cold metal' describes how the wind felt</b>	<b>Five senses</b> - to show how something looks, sounds, feels, smells and tastes, e.g. The rain had the feel of <b>cold metal</b> against our faces.'	<b>Adverb - furiously - describes how waves lashed</b>



# READING TASK 6

TYPES OF TEXT	FEATURES
<b>Persuasive Texts</b> (e.g. advertising)	When writing to persuade the writer's aim is to make the reader do something or believe something.
	<b>Emotive language</b> Sometimes a writer will use words or phrases to make the reader feel a particular emotion, e.g. sadness, anger, guilt etc. <i>'Cowboy builders are conning the elderly and most vulnerable in our society.'</i>
	<b>Facts and Statistics</b> When factual information is given to support a point of view, e.g. <i>"More than 70% of people living in the western world live in timber framed houses."</i>
	<b>Opinion presented as if it was fact</b> When information is given to support a point of view but cannot be proved.
	<b>"Most people prefer bungalows to live in"</b> <b>Repetition</b> Repeating a particular word, phrase or idea throughout the text emphasises the point that the writer is making. <i>"Building Houses, Building Community, Building Hope"</i> (Habitat for Humanity poster)
	<b>Rhetorical questions</b> These make the reader think about what is being asked. They also aim to involve the reader, making them think that their opinion is important. <i>'Is it worth all the bother of moving when a roof or cellar conversion can give you the space you need?'</i>  <b>Presentational features</b> Presentational features organize and emphasise certain parts of the text. Layout, use of image, text features e.g. headings, subheadings, use of colour, diagrams, bold/italic lettering, underlining, font size/style, bullet points and numbering
	<b>List of three</b> When three adjectives or phrases are used to emphasise a point, e.g. <i>'The new Building Supplies Store was <b>light, bright and airy.</b>'</i>  <b>Exaggeration</b> Makes something appear really good or really bad. <i><u>Best Ever</u> Sale of Building Materials in Northern Ireland!</i>

# READING TASK 6

TYPES OF TEXT	FEATURES
	<b>Use of supporting viewpoints</b> Using expert opinion or quotes from famous people to make a viewpoint appear more convincing.
	<b>Question and answer</b> Used to draw readers' attention to particular aspects of an issue.
	<b>Criticise the other person's point of view.</b> This is where the writer attacks the opposing argument to make their own argument seem better.
	<b>Alliteration</b> Use of the same sounds at the beginning of words catches the reader's attention e.g. <i>'Thompson's Tried and tested timber'</i>
	<b>Personal pronouns</b> Using words such as 'I', 'we', 'you', 'our', 'us', to make the reader feel the writer is speaking directly to you. <i>'We can give you great tips on preparing your house for the market.'</i>
	<b>Pun</b> A play on words to make them stand out and attract the reader's attention <i>'Timber-frame homes <u>wood</u> never let you down'</i>

# READING TASK 6

**Are the following texts information, instruction, descriptive or persuasive?**

## 1. Replacing a Damaged Plug

1. Unscrew and remove the cover of the damaged plug.
2. Turn the plug over and slacken the terminal screws.
3. Pull the flex cores from the pins.
4. Loosen the screws securing the flex clamp.
5. Pull the flex free.

Type of text \_\_\_\_\_

## 2. Titanic Floats Again!

Belfast's Titanic Quarter, Europe's largest riverside rejuvenation project, is breathing new life into Queen's Island, the home of the famous Harland and Woelf shipbuilders. It is from this very slip that the RMS Titanic, a legend before even she set sail, set out proudly on her doomed maiden voyage in April 1912.

RMS Titanic, was the largest and most luxurious ship afloat. No expense was spared on her elegant furnishings to charm her wealthy passengers. Despite the gloomy outcome, when RMS Titanic embarked on her ill fated maiden voyage, she was hailed as 'new wonder of the world.'

Type of Text \_\_\_\_\_

## 3. Holiday Apartment - Spain

Sleeps four. Wonderfully situated, air-conditioned two bedroom holiday cottage. Exclusive private pool and gardens with outstanding mountain views. Stunning sea views. Peaceful location, ten minute drive from large supermarket and shopping mall. Peaceful location, five minute walk from beaches and promenade. Close to bars, restaurants and nightlife. A sporting paradise, five minute drive to golf. Ideal for your relaxed holiday in Spain's healthiest and sunniest climate. £430 per week

Type of Text \_\_\_\_\_

# READING TASK 6

## 4. Listed Buildings

After the Second World War the government created a list of endangered buildings. Listed buildings are buildings that the government feels are in need of protection from being demolished or changed unsympathetically. Throughout the UK there are different methods of classifying buildings but the aims are the same. At the highest level of grading you cannot make changes to the building and replacements must be identical to the original. Lower down the scale changes are possible but must be reviewed by the administering body prior to renovation.

Type of Text \_\_\_\_\_

# READING TASK 7

## TYPES OF TEXTS - WRITING TO INSTRUCT

### Instructions

#### Reading Task

In the course of your work you will often read or write instructions. Instructions are not just pieces of advice or suggestions about how to carry out a job. Instructions are about how a job **MUST** be carried out so that the end result is a job completed safely and to the proper standards.

#### Features of Writing to Instruct

1. Instructions must be written in the correct order. When carrying out instructions for a construction job you could waste time or cause annoyance or even injury to yourself or others if following instructions that are in the wrong order.
2. Only relevant information should be included. Extra information could confuse the person following the instructions.
3. Instructions should be clear and easy to follow.
4. Instructions are given in a series of clear simple commands or directions. The verbs give commands, e.g. **'Stop here'** and are often found at the beginning of a sentence. They clearly state what the person should do.
5. Instructions are written in the present or future tense as if the action is happening now. e.g. **Press** the button and a light **will come** on.

**Command verb  
or imperative  
verb.**

**Future Tense**

**Present tense**

#### Activity 1

The funds are running a little low and you have jumped at the chance to do a little bit of DIY in your uncle's new house while he's on holiday. Below are two sets of instructions. Which set is more effective? Give reasons and examples. (Remember to check the list of features of instruction texts).

#### 1. Painting Job

- Clear the room before you start.
- Place anything that needs to stay in the centre of the room.
- Use dust sheets to cover items.
- Fill any cracks or holes.
- Wash down with sugar soap solution. (Use protective goggles and gloves).
- Prime walls.
- Paint ceiling first.
- Then paint walls
- Finally paint the woodwork.

# READING TASK 7

## 1. This set of instructions is effective / not effective because:

## Activity 2

### 2. Painting Job

“See before you start, Chris, would you check if the dog’s bowl has water, because we’re away from 5 o’clock this morning and the neighbour can’t pick him up until 10am. If I were you, I would get as much furniture out of the room as possible and anything you can’t move sure just put it into the middle of the room with a couple of dust sheets over the top. Take a look and see if there are any cracks or holes that need fixing up before you start. You’ll need to paint the ceiling first in case the paint drips down onto the walls and then paint the walls and then the skirting boards and doors. After you’ve filled in the cracks or holes you’ll need to wash the walls down with the sugar soap solution. Make sure you put the old goggles and gloves on for the sugar solution wash – the last time I did it my eyes stung for a week!!!! And don’t forget to prime the walls after the sugar soap solution wash has dried.

## 2. This set of instructions is effective / not effective because:



# READING TASK 7

## Activity 3

### 3. Which of these sentences are instructions?

- a. Pour concrete into the foundation trench.
- b. Timber framed walls differ from those constructed of traditional brick and block.
- c. Windows are available in a variety of shapes, sizes and materials.
- d. Make sure timber frame structures comply with the building regulations.
- e. Carry out the procedure in the correct order.
- f. Allow background to finishes to dry properly.
- g. Hardwood stairs may not be installed until all plastering has been completed.
- h. A plaster finish on masonry walls will last between 50-100 years.
- i. Common brick is used for unseen work and is much cheaper than facing brick or engineering brick.
- j. Place fibre glass insulation into cavity wall.

### 4. Now make out a set of instructions for the following tasks.

The instruction verbs below may be useful.

- a. Instructions for using a ladder.
- b. Instructions for using scaffolding.
- c. Instructions for mixing concrete

fill	put	cut	dry
pour	check	stir	brush
fit	add	divide	mix
cover	place	use	fold
overlap	link	take	lift

# READING TASK 8

## TYPES OF TEXTS - PERSUASIVE WRITING

### Testimonials

Writers use a range of techniques to engage the reader. Writing to persuade aims to make the reader do something or believe something. The following testimonials express customer satisfaction with a firm of plumbers on the quality of their work.

### Activity

Greg Vaughan is from Northern Ireland and has run a successful plumbing business in Boston for twenty years. The writers of the testimonials below on his company use a number of persuasive techniques. Read the testimonials and then answer the following questions.

### Vaughan Plumbing and Heating

1. "Greg Vaughan, owner of Vaughan Plumbing and Heating is trustworthy, professional and hard working. His rates are fair, and he gets the job done. His many years of experience have made him an expert in his field. If you are a home owner, property manager, real estate agent, insurance agent, you owe it to yourself to add Vaughan Plumbing to your rolodex. Call Greg if you want the job done right the first time." - Jonathan S., Brookline, MA

**Read this and other testimonials for Vaughan Plumbing & Heating at [Yelp.com](#).**

2. "Greg did a great job installing my new water heater and garbage disposal. He's very honest, straightforward, and punctual. I will definitely hire him again." - Jyothi V., Waltham, MA

**Read this and other testimonials for Vaughan Plumbing & Heating at [ServiceMagic.com](#).**

3. "Greg is courteous and reliable. He came to fix my toilet in a short notice and showed up at the time he promised. He also diagnosed the problem up front and provided a quote for the job. He completed the job quick and easy, very neat and cleaned up afterward. He is friendly and he takes his time to explain the job. I would call for his service again in the future and highly recommended."

**Read this and other testimonials for Vaughan Plumbing & Heating at [Bing.com](#).**



**Greg Vaughan, Owner**

# READING TASK 8

**1. Who do you think is the intended audience for these testimonials?**

**2. What is the purpose of the testimonials?**

**3. On the basis of these testimonials would you hire this plumber?**

**4. Why?**

## READING TASK 8

**5. How does the use of an image (photograph of the owner) help to persuade you that this is the plumber you want to hire?**

**6. Give two examples of where facts or statistics are used to support the points of view of the writers.**

**a**

**b**

**7. There are a number of positive words and phrases used to describe Greg and his work. Make a list of them.**

## READING TASK 8

- 8. In two of the testimonials the persuasive technique 'list of three' adjectives is used to reinforce the writer/s viewpoint. Identify and write out two 'list of three' groups the writer/s has used.**

- 9. Writers use personal pronouns ('I' 'we' 'you' etc) to show that the writer is speaking directly to the reader. This is to show that the readers' opinion is important to them. Give an example of where the writer directly addresses the reader.**

- 10. Writers use emotive language to appeal to the positive or negative feelings of the reader. Identify four emotive words in the testimonials.**

## READING TASK 8

11. Notice how words and key ideas are repeated throughout the testimonials. This helps to reinforce the point being made. Give an example of repetition in the three testimonials.

12. In the first testimonial the writer appeals directly to the reader, **“you owe it to yourself** to add Vaughan Plumbing and Heating to your rolodex.” Explain how the bolded phrase would help to persuade the reader to hire this firm of plumbers.



# READING TASK 9

## ANALYSING A NEWSPAPER ARTICLE

At Level 2 you will be closely analyzing texts of 500 words or more, both for the Action-based Activity (project/portfolio) and the Desk Top Task (final exam).

You will need to identify:

1. The intended audience of the text.
2. The purpose of the text – why was the text written?
3. Is there more than one viewpoint presented?
4. The events that led the writer to produce the article.
5. The main idea of the article.
6. The arguments the writer is putting forward.
7. Facts / statistics / quotes from expert witnesses etc that support the writer's main arguments – his/her sources of information.
8. If the reporting is true (balanced) or biased?
9. Different points of view given by the writer.
10. Is the article balanced, persuasive, informative, convincing.
11. Your own feelings about the article. Do you agree with the writer's point/s of view?

### Activity

Read the article "Move or Improve" below and analyze the article using the list above.

Write your answers in full sentences which are properly punctuated. If you are using quotes from the text to back up your comments remember to enclose them in inverted commas e.g.

Jeremy Leaf, a spokesman for the Royal Institute of Chartered Surveyors says, "Moving up the ladder is very difficult."

# READING TASK 9

## MOVE OR IMPROVE?

**Hannah Booth**

**The Guardian**  
**16th July 2007**

Soaring property prices and the prohibitive cost of relocating are preventing many people climbing the housing ladder. Now more and more of us are instead opting to extend our homes.

Thinking of moving house? Think again. The next rung of the housing ladder may have been within reach a few years ago, but it is becoming increasingly hard to upgrade to a larger property: the apparently unstoppable rise in house prices, the lack of decent properties, the sheer expense of moving house - from stamp duty to solicitors' fees - are making us question whether it is worth it. It is no surprise that a growing number of homeowners are deciding that enough is enough: we move house primarily to gain space; why not stay put, save on moving costs and spend the money on improving what we have?

Extending your home is typically a lengthy process of applying for planning permission for the smallest of alterations, and awaiting approval. But the government is aiming to cut red tape, making the process easier and faster. In May, it announced proposals to allow most loft and kitchen extensions without planning permission, provided they meet certain size criteria.

So why are we finding it so difficult to move house? According to the Halifax, the average costs are as follows: valuation, £300-£600; conveyancing, £400-£600; and estate agency fees, usually around 1-2% of the property's value. Then there's stamp duty: 1% on houses from £125,000 to £250,000; 3% for houses worth £250,000 to £500,000; and 4% for houses over £500,000. The average house price in the UK, according to the Halifax, is now £196,893; in London, £297,132: that's £1,969 in stamp duty (or nearly £9,000 on the London average). So, at the most conservative, we're spending £4,700 just to move (£12,700 in London).

It doesn't stop there. There is wasted money if a sale falls through and bridging loans if you have to pay two mortgages simultaneously. Your house may not fetch the asking price. You may end up having to offer more for the house you want, or resort to sealed bids. There is the cost of physically moving your belongings (depending on how far you're travelling and how much stuff you have, upwards of £300). In fact, research by Abbey suggests that factoring in these costs takes the total cost of moving to nearer £16,000 - and says the average homeowner then spends a further £6,000 in the first year doing up their property, furnishing and decorating it. That's £22,000 - ouch.

More importantly, as prices continue to rise, we're not getting significantly more for our money. "Moving up the ladder is very difficult," says Jeremy Leaf, an estate agent and also spokesman for the Royal Institute of Chartered Surveyors (RICS). "Often, people are looking to make two 'jumps' - a bigger home in a better area - which makes it doubly difficult. They're increasingly thinking, is it worth the effort? The leap between a three-bed and a four-bed house is particularly hard. Four-bed houses are popular, relatively rare and usually considerably larger and in better areas. And you're competing with people who are settled in the area, with good friends, schools, jobs, who are prepared to pay the extra."

# READING TASK 9

The alternative? Spend the money on a loft conversion or extension. Aside from saving on moving expenses, you get to keep your neighbours (which may or may not be a good thing), your schools, and the vegetable patch you have worked so hard on. A growing number of us are doing just this. Planning applications have nearly doubled in the past 10 years, according to the government. In the past 12 months, says the Halifax, just 3% of home improvers converted a loft; next year, 10% are planning to do so.

"People can't afford to move these days," says Neil Yemm, director of Midlands-based loft specialist Main Pride Lofts. "Most want an extra bedroom and, increasingly, an office as so many work from home now. What my clients do is work out what they'd have to pay in stamp duty and costs if they were to move, and spend it on an extension instead."

The government's proposals are designed to improve the quality of extensions you can make without permission - ministers are concerned about the time involved in deciding minor, uncontroversial applications. At present, homeowners have to pay up to £1,000 to obtain planning permission for almost all rear and roof extensions, a process which can take between eight and 16 weeks. Under the proposals, no planning permission will be needed for these types of extensions if they have little impact - rather, there will be self-assessment or direct negotiation with a local authority to ensure extensions comply with height and depth restrictions. And there are no limits on the number of extensions you can build - under current law, if you have extended by 10%, you have used up your limits and must seek planning permission.

The average cost of an extension, according to RICS' Building Cost Information Service, is anything from £14,000 for a modest loft conversion to £50,000 for a large kitchen extension.

Lance Stock, who runs Barnet-based Stock Construction, usually allows £30,000-£35,000 for kitchen/dining room extensions and loft conversions on an average three-bed semi. "Loft conversions are more popular than garden extensions because you're often getting a third or fourth bedroom, and even a second bathroom - and that's more attractive when you eventually come to sell." He says people who convert their lofts can usually expect the value of their house to rise by two or three times the price of the extension. Costs rise if you employ an architect: on average, a bespoke kitchen or basement extension starts at around £40,000. You could equally spend £200,000 for a larger extension with a high-spec kitchen.

"The single biggest cost when considering an extension is VAT. Our clients often forget to factor it in - a quote always excludes VAT so it can come as a bit of a shock," says architect Alun Jones, whose practice, Dow Jones, has built several extensions. On a £40,000 extension, 17.5% VAT is £7,000. But you're adding value to your home. "You get more value for money by extending your property," he says. "Stamp duty is such a waste - particularly on expensive properties. On a house worth £750,000, you'd pay £30,000 - the cost of a loft conversion."

So is it worth it? "If an extension is well designed, yes, every time - it will always add more to the value of the house than what it cost, usually at least double what the extension cost," says architect Paul Archer. "But the cost must be proportional to the value of the house. You wouldn't spend £200,000 on a £150,000 house; and equally, you wouldn't spend £30,000 on a £2m property. But beware: a poorly designed extension may devalue a property."

# READING TASK 9

Stock recently built a loft conversion in a three-bed semi in north London for £30,000 plus VAT, with an additional £5,000 spent on decorating (total cost, around £40,000). "My client had his house valued four weeks later, and it was worth £82,000 more. And that's a pretty standard uplift."

The proposals are stricter on loft extensions you can undertake without permission. The government is keen to reduce the visual impact of bulky dormer windows - they are one of the biggest causes for complaint between neighbours - by limiting their size. Under the new proposals, discreet extensions built below the ridge of the roof and away from the edge may not require permission - and conversions with no external changes, including skylights that open out, are allowed without planning permission.

"The proposed changes take into account the impact of building work, rather than being prescriptive for the sake of it," says a spokesman. "For example, how far buildings are from neighbouring properties, whether they drastically alter the look of a house, whether they are the appropriate size for the size of the house." Planning permission will, however, still be needed in certain cases - where they are larger than allowed, in listed buildings, and in conservation or protected areas. Final proposals should be published later this year with a view to being implemented next year.

But not everyone's happy. "For kitchens and conservatories, the proposals are good news," says Brian Berry, director of external affairs at the Federation of Master Builders. "But for anyone thinking of converting their loft, it's really bad news. The proposals essentially shrink the size of a permitted loft conversion, so you have to get planning permission anyway."

"Under the government's proposals, people will find that home renovation is harder, not easier, to achieve," agrees Jeremy Leaf of the RICS. "Requirements for loft conversions will make it difficult to create sufficient space for a new room, and will force people to apply for formal planning permission, which defeats the purpose."

"We appreciate those with a vested interest, such as builders, may be concerned," says a government spokesman. "But we're aiming for a balance between homeowners and their neighbours. People can extend their lofts, it's just that for larger schemes that may impact on others, they will have to seek planning permission."

# READING TASK 10

## READING IMAGES

We often use images (photographs, maps, charts, graphs, etc) to gather information or to put information across.



There are many health and safety signs used in the workplace to alert employees and customers to dangers.



DIY instructions on store leaflets can also often be illustrated by pictures that show how a job should be carried out.



In the course of your work you may need to take information from architect's drawings.

# READING TASK 10

## USING IMAGES



It is useful to have photographs of the various stages of development in a new build. This photograph shows the progression of the foundations in a domestic dwelling.



This picture illustrates a domestic construction with a steep pitched roof allowing for dormer windows which creates additional head room in the roof space and allows for the roof space to be utilised for habitable rooms.



Pictures of our local natural environment such as this one of the Giant's Causeway can provide information to those who have never visited and this type of photographic evidence of this natural attraction is vital for our tourist industry.

# READING TASK 10

## PUTTING THE MESSAGE ACROSS

Here are two similar site safety signs for personal protective equipment. The audience and purpose of both signs are the same.

They are written for construction site workers and both signs are intended to keep site workers safe.

Which of the signs do you think puts the message across most effectively? Why? Write about each of the signs saying why you think one is more effective than the other. Say how each writer uses language to put across the message.

1.



2.





# READING TASK 11

## PRACTICE FOR DESK TOP TASK - PART 1

### Bricklayers Help Build Houses for Habitat for Humanity



Twelve Brickwork Apprentices from South Eastern Regional College (SERC) Newtownards campus were given an opportunity to participate in a Habitat for Humanity programme assisting in the construction of the ECO Housing Scheme on the 'Peace Line' between Templemore Avenue and the Short Strand in East Belfast.

Habitat for Humanity [HFH] is a non-profit, Christian housing organisation that works in partnership with families in need of shelter to build decent homes. HFH was founded in 1976 and has since built more than 300,000 houses around the world, providing more than 1.5 million people with safe, decent, affordable shelter.

Most of the work which was carried out by the apprentices was not directly related to their training or course work, but was still extremely beneficial as it provided an insight into the different aspects of construction and how trades interlink and rely on each other.

SERC Brickwork Lecturer Darren Gregg had this to say, "It's been a fantastic experience for our students as they got the opportunity to practice the skills taught in College. Our Apprentices listened intently to the representatives from Habitat for Humanity, as they described the deprived living conditions of people less fortunate than us, in other countries of the world, in which they have worked. The day was a great insight into the 'real world' for some of our Apprentices."

The onsite experience proved to be very satisfying for the apprentices as they realised that their efforts were directly linked to the speed at which an underprivileged family would receive their new home from Habitat for Humanity.

# READING TASK 11

Read the article on Habitat for Humanity and answer the questions below. The questions are similar to the ones you will be asked in Part One of the Essential Skills Literacy Desk Top Task.

**1a. Identify the reason for the Habitat for Humanity project.**

**1b. Name two ways in which the apprentices benefited from their work on the project.**

- 1.
- 2.

**2a. Identify two words or phrases used by the writer to describe the families in need of shelter.**

- 1.
- 2.

# READING TASK 11

**2b. Suggest a reason why the writer has used these words/phrases.**

1.

2.

**3a. Give an example of where opinion is presented as fact.**

**3b. The writer describes the experience of the apprentices as “fantastic” and “satisfying.”  
Say why the writer uses this style of language. In other words what effect do these words have on the reader?**

# READING TASK 11

**4. Explain in your own words how the photograph of the apprentices supports the view of the writer.**

**5. Imagine you are going to give a short talk in support of the Habitat for Humanity project.**

Using information from the article:

**5a. Summarise two arguments you would use to support your view.**

1.

2.

**5b. Explain why you might use these arguments in your talk.  
(Persuade, convince listeners etc)**

1.

2.

# READING TASK 11

**6. Using the article identify and explain three techniques used by the writer to support his/her views.**

**1.**

**2.**

**3.**

# READING ANSWERS TASK 1

PRESENTATIONAL FEATURE	FEATURE IN LEAFLET.	PRESENTATIONAL FEATURE	FEATURE IN LEAFLET
Heading	✓	Graphs	
Subheadings	✓	Logo	✓
Diagrams	✓	Bold print	✓
Use of colour	✓	Italics	✓
Different size print	✓	Bullet points	✓
Different font types	✓	Underlining	✓
Unusual use of capital or lowercase letters	✓	Numbering	✓
Photographs	✓		

## Task Answers

1. Colour is being used to make the leaflet more appealing to the reader. It also helps to separate out some pieces of information.
2. The effect of heading and subheadings.  
The title of the leaflet is printed in larger print than the rest. It is written in white on a green background. The sub-headings are smaller than the title and are written in green print on a white background.
3. Why numbering and bullet points are used.  
Bullet points are used to list the DIY instructions for each step of the job making the text easier to follow.
4. Is different print size or bold print being used? What for?  
The title of the leaflet is in larger print than the rest of the text making it stand out.
5. This is one of Homebase's 'How to...' leaflets. Why is the company's logo important to the text?  
Homebase is a reputable company and product with the Homebase logo would be seen to be trustworthy.
6. Why photographs and diagrams are being used (rather than just more words). Photographs and diagrams are used to illustrate and clarify points made in the text. They show the tools to use and the way the job should be done in a way that is much clearer than just reading information.

# READING ANSWERS TASK 2

## Sample Answer – Highlighted main points of ‘Design methods that take account of renewable energy resources.’

Building regulations and design methods must take account of renewable energy resources. Energy is essential to almost everything we do, from heating our homes to sustaining industry. We have come to rely on it in almost every aspect of our lives.

Fossil fuels (oil, coal and gas) are used to create reasonably affordable energy but, unfortunately, the burning of fossil fuels releases vast amounts of carbon dioxide (CO<sub>2</sub>) into the Earth’s atmosphere creating global warming. Fossil fuels are also not sustainable. They will eventually run out.

Brundtland (Brundtland Commission 1983) defined sustainability as “Meeting the needs of the present without compromising the ability of future generations to meet theirs.”

To ensure energy sources were available to future generations, sustainable sources needed to be employed, and in 2003 the Energy White Paper outlined a long term strategic vision for energy policy. It looked at environmental issues, social targets, competitiveness and security of supply.

The Energy White Paper promotes the take up of renewable sources. It commits the United Kingdom to reducing emissions of greenhouse gasses by 60% by the year 2050. As 46% of carbon emissions relate to building occupation the EU has issued a directive on energy rating for buildings and regional building regulations have been revised.

There is now a shift towards energy sources and generation technologies that produce much less or even no carbon. Renewable energy is created from resources that occur naturally in the environment. These resources also occur repeatedly and so are renewed or replaced over a short period of time.

### Types of Renewable Energy

Sunlight, Wind, Water, Sustainable Biomass, Waves, Tides and Geothermal sources are natural processes that can be replenished over a relatively short period of time and are seen as inexhaustible

### Wind Energy

These images show the wind turbine at Antrim Area Hospital. In the first year in which it was installed this generating plant saved the Hospital approximately £100 000 from its electricity costs. This was about one fifth of the cost which was required to install the turbine.

### Geothermal Ground Pumps

Ground source heat pumps are one of the most common types of heat pumps. Typically a cold fluid at about 5 degrees Celsius is circulated around a network of plastic pipes buried in the ground. As the fluid passes through the pipe it absorbs heat energy from the surrounding earth. The fluid returns to the heat pump slightly warmer than it left. The heat pump upgrades the heat to a higher level of 40 to 50 degrees Celsius to provide heating in the home. This water can then be circulated round radiators, under floor heating pipes or provide domestic hot water.

# READING ANSWERS TASK 2

## **Solar Energy**

Energy from the Sun can be harnessed to generate Electricity or heat water. This photograph below shows the large solar panels on the roof of the ECOS centre Ballymena. The energy from these panels is used in the office building.

## **Biomass**

Biomass is the harvesting of willow trees to supply fuel for central heating using a specially adapted burner. The willow is grown in short-rotation crop and is harvested every two to three years with a specially adapted harvester. It can then be burned directly or made into pellets which are more efficient

This type of willow crop can be seen growing at the ECOS centre Ballymena

## **Summarising Activity**

**When you buy the materials to build your shed make sure you have everything you need for the job.**

There is nothing worse than being in the middle of a job and having to down tools and go to the building suppliers (if they're open) to buy things like screws, nails and so on, especially when you thought they were to hand in the first place.

### **66 words**

Main point/s of 'Building a Shed' paragraph.

- Make sure you have all the equipment you need before starting to build your shed.

### **16 words**

\*Notice that this information was given in the first sentence of the paragraph. It is often the case that the main point of the paragraph is given in the first sentence – a good thing to remember when reading and selecting the main points of a paragraph.



# READING ANSWERS TASK 2

## Sample Answer - Main Points of Article

1. Building regulations and design methods must take account of renewable energy resources
2. Fossil fuels (oil, coal and gas) are affordable sources of energy but release a lot of carbon dioxide into atmosphere and increase global warming.
3. Fossil fuels are not sustainable. They will eventually run out.
4. Sustainable sources need to be used to make sure there are energy sources available to future generations.
5. In the 2003 Energy White Paper the government outlined a future energy policy to look at environmental issues, social targets, competitiveness and security.
6. The government promotes the take up of renewable sources and is committed to reducing UK CO2 emissions by 60% by 2050.
7. 46% of carbon emissions relate to buildings and building regulations have now been changed.
8. There is now a move towards using energy sources and generation technologies that produce as little carbon as possible.
9. Renewable energy is created from resources that occur naturally in the environment and are replaced over a short period of time.
11. Types of renewable energy are sunlight, wind, water, sustainable biomass, and geothermal sources (pipes of water which absorb heat energy from the earth).
12. Use of renewable energies in Northern Ireland include wind turbine at the Antrim Area Hospital which saved the hospital approximately £100,000.
13. Large solar panels are used at the ECOS centre Ballymena and also biomass (willow trees) for central heating.

**Source: CITB-ConstructionSkills Northern Ireland**

**Title: Design methods that take account of renewable energy sources.'**

**Author: A Reporter**

**Date: 26:05:10**

# READING ANSWERS TASK 3

Your written summary should not contain any of the information that is highlighted in blue.

## Air Quality

Air quality needs to be considered as poorer quality of air can cause health and breathing difficulties in the long term as well as some short term effects. **This is important because I know from first hand the problems of poor air quality. My grandmother had asthma and my sister takes after her - not just in looks - she has asthma too and has been to hospital three or four times.** Also if a company's emissions are to be the cause of the problem the company can be liable to legal action. So less harmful emissions in the air is better all round for the company, environment and the general public.

## Ozone Layer

The ozone layer has also to be considered as greenhouse gasses such as CO<sub>2</sub> and CFC's are causing a harmful affect on it and the ozone layer is letting in some of the sun's harmful UV rays. Also heat is being trapped on top of this. **I don't know what all the fuss is about to be honest. We could do with a bit more sun and heat in Ireland.** Areas being affected by this are Antarctica and Southern Chile because there is a hole in the ozone layer. The harmful greenhouse gases are causing global warming which affects everyone.

## Landscape / Preservation Orders

Landscape also influences the design decision as the landscape of the area you may plan to build a project on may have preservation orders on them. **I once lived in a house which had a preservation order on it. It was over two hundred years old with thick walls and a narrow driveway which was built for horses and not for cars.** Preservation orders must be considered before and during the construction project.

# READING ANSWERS TASK 4

Feature	Formal or Informal
Incomplete sentences	Informal
Complex sentences	Formal
No contractions	Formal
Slang	Informal
Short simple sentences	Informal
Easy words	Informal
Abbreviations e.g. gr8	Informal

Letter of application	Formal
An internal company memo	Formal
Email invitation to 18th birthday party	Informal
Letter of opinion to local newspaper	Formal
A mobile phone text to a friend	Informal
A holiday postcard	Informal
A post it to a family member	Informal
A company report	Formal

# READING ANSWERS TASK 5

**1. Skim read the text below and, in just one or two sentences, say what the article is mainly about.**

The article is about how renewable energy resources are replacing fossil fuels such as oil, coal and gas in line with Building Regulations.

**2. Scan the text to find and list the sources of renewable energies discussed.**

Sources of renewable energies are sunlight, wind, water, sustainable biomass and geothermal ground pumps.

**3. What are renewable energies?**

Renewable energies such as are sunlight, wind, water, sustainable biomass, waves, and Geothermal sources are natural processes that can be replenished over a relatively short period of time and are seen as inexhaustible.

**4. Why are renewable energies now favoured over fossil fuels?**

Fossil fuels (oil, coal and gas) are used to create reasonably affordable energy but, unfortunately, the burning of fossil fuels releases vast amounts of carbon dioxide (CO<sub>2</sub>) into the Earth's atmosphere creating global warming. Fossil fuels are also not sustainable. They will eventually run out.

**5. How is biomass produced and what is it used for?**

Biomass is the harvesting of willow trees to supply fuel for central heating using a specially adapted burner. The willow is grown in short-rotation crop and is harvested every two to three years with a specially adapted harvester. It can then be burned directly or made into pellets which are more efficient.

**6. How does Brundtland define 'sustainability?'**

Brundtland (Brundtland Commission 1983) defines sustainability as 'Meeting the needs of the present without compromising the ability of future generations to meet theirs.'

# READING ANSWERS TASK 6

1. Instruction
2. Descriptive
3. Persuasive
4. Information

# READING ANSWERS TASK 7

## Activity 1

### Painting Job

This set of instructions is effective because:

- a. It is set out in order.
- b. It is clear and easy to follow.
- c. It is written in the present tense e.g. 'Fill any cracks'
- d. It uses verbs to command (imperative) e.g. 'Clear the room before you start.'
- e. Only relevant information is included.

## Activity 2

### Painting Job

This set of instructions is not effective because:

- a. The instructions are not in order.
- b. It is not clear and easy to follow.
- c. It contains a lot of information that is not relevant.

## Activity 3

**These are instructions. The verb/verb phrase is bolded in each sentence.**

- a. **Pour** concrete into the foundation trench.
- d. **Make sure** timber frame structures comply with the building regulations.
- e. **Carry out** the procedure in the correct order.
- f. **Allow** background to finishes to dry properly.
- j. **Place** fibre glass insulation into cavity wall.

# READING ANSWERS TASK 8

1. The intended audience for the testimonials is anyone who is looking to hire a plumber.
2. The purpose of the testimonials is to let other customers know how reliable or otherwise this firm of plumbers is.
3. Yes.
4. I would hire this plumbing firm because of the positive comments written by previous customers.
5. Using a photograph of the owner helps the customer to 'get to know' Greg Vaughan. The photograph shows Greg smiling and gives the impression of someone with an open, cheerful personality that appeals to the customer.
6. a. 'Greg did a great job **installing my new water heater and garbage disposal.**'  
b. He came to **fix my toilet**  
(The bolded phrases give facts that support the writer's point of view).
7. Positive words and phrases that occur in the testimonials are listed below.

trustworthy	expert in his field	fair
professional	gets the job done	punctual
hard working	job done right	neat
did a great job	very honest	straightforward
highly recommended	reliable	courteous
up front	friendly	

- 8.a. "Greg Vaughan, owner of Vaughan Plumbing and Heating is **trustworthy, professional and hard working.**
- 8.b. 'He's very **honest, straightforward, and punctual.**'
9. '... **you owe it to yourself** to add Vaughan Plumbing to your rolodex.'
10. Words and phrases that appeal directly to the readers emotions are honest, trustworthy, up front, friendly, professional, courteous, reliable, fair.
11. An example of words and key ideas that are repeated throughout the testimonials to help reinforce the points being made is,  
  
Testimonial 1 – 'he gets the job done.'  
Testimonial 2 – 'did a great job'  
Testimonial 3 – 'completed the job quick and easy'  
(You might have chosen other key ideas e.g. 'honesty')
12. The writer of Testimonial 1 says '**you owe it to yourself** to add Vaughan Plumbing to your rolodex.' By addressing the reader directly like this we are made to feel that the writer is speaking personally to us and that we are important to the writer. This phrase also makes us feel that we deserve the excellent services of Vaughan Plumbing. (Remember the ladies face cream advert 'Because I'm worth it?')

# READING ANSWERS TASK 9

## READING AND UNDERSTANDING A NEWSPAPER ARTICLE.

**1. The intended audience of the text.**

The intended audience for this article is home owners who are deciding if they should move home or improve the home they are living in at present.

**2. The purpose of the text – why was the text written?**

The text was written to outline the advantages and disadvantages of moving house or improving an existing home.

**3. Is there more than one viewpoint presented?**

The article looks at the advantages and disadvantages of moving or improving from a number of points of view including those of the homeowners, builders and neighbours.

**4. The events that led the writer to produce the article.**

The article was written in response to the government's plans to introduce new laws making it easier to make home improvements since planning permission will not now be needed for certain types of conversions.

**5. The main idea of the article.**

The main idea of the article is that it is better to make home improvements rather than to move house.

**6. The arguments the writer is putting forward.**

- a. It is too expensive for most people to move to larger homes.
- b. New government regulations are making it easier to obtain planning permission for home conversions so that home owners can develop their existing properties and raise the value of their homes.

**7. Facts / statistics / quotes from expert witnesses etc that support the writer's main arguments – his/her sources of information.**

Hanna Booth writing for the Guardian says "Thinking of moving house? Think again. The next rung of the housing ladder may have been within reach a few years ago, but it is becoming increasingly hard to upgrade to a larger property: the apparently unstoppable rise in house prices, the lack of decent properties, the sheer expense of moving house - from stamp duty to solicitors' fees - are making us question whether it is worth it."

"It is no surprise that a growing number of homeowners are deciding that enough is enough: we move house primarily to gain space; why not stay put, save on moving costs and spend the money on improving what we have?"

Also Neil Yemm, director of Midlands-based loft specialist Main Pride Lofts says "People can't afford to move these days, most want an extra bedroom and, increasingly, an office as so many work from home now. What my clients do is work out what they'd have to pay in stamp duty and costs if they were to move, and spend it on an extension instead."



# READING ANSWERS TASK 9

**8. Is the reporting is true (balanced) or biased?**

Reporting is balanced since it looks at advantages and disadvantages of moving home and gives the pros and cons of moving or improving existing property. This gives home owners the opportunity to make informed choices.

**9. Different points of view given by the writer.**

People are thinking of improving their homes rather buying larger homes. Buying larger homes is very costly. New government regulations are making it easier to make improvements to existing properties.

**10. Is the article balanced, persuasive, informative, convincing?**

The article is balanced in that it presents opposing views regarding moving or improving homes. It is persuasive and convincing in that it presents persuasive arguments for converting existing homes rather than moving home. It does this by presenting factual detail to support the opinions of the author.

**11. Your own feelings about the article. Do you agree with the writer's point/s of view?**

I think that the article thoroughly explores the problems of moving home. If a home owner has the home they want, in an area that suits them, but is in need of a little extra space, then I think that extensions and / or conversions are the answer.

# READING ANSWERS TASK 10

## **Sign 1 is not as effective as Sign 2 because:**

It is less attention catching. It is written mainly in lower case letters which is not as attention catching as the capitals in Sign 2.

The sign says 'PPE must be worn in this area' but gives no indication of what might/will happen (injury, death, sacking etc) if PPE is not worn.

It is also open to interpretation. Where exactly does 'this area' refer to? Where are the boundaries? If I step back a few meters from the sign can I take off my hard hat without getting a warning? With sign one a site supervisor might have to listen to a list of excuses e.g.

'I thought I only needed my hat over there.'

'I thought I only needed my boots for this job.'

'He said I didn't need a high visibility jacket for this job.'

'Anyway, how am I supposed to know that hi-viz means high visibility?'

'Nobody told me ...'

## **Sign 2 is more effective than Sign 1 because:**

It gives a very strong and clear message.

It clearly lists the PPE needed for the site and states the consequences of not wearing the proper PPE for the job.

It is written in block capitals to stress the importance of what is being said. (As Russell Brand said when reading a letter on a recent comedy show "When I say something loudly then that thing is in capitals.")

It does not use the term PPE but instead uses the normal everyday language we all use, e.g. HAT, BOOTS etc.

High visibility clothing is clearly illustrated and coloured yellow so there is no misunderstanding the term Hi-Vis.

It ends with a dramatic statement 'NO JOB!' (note the exclamation mark for emphasis) to stress that anyone not wearing appropriate PPE will be sacked.

There is no room for interpretation of this sign and it clearly puts across the message that there are 'NO EXCUSES!'

# READING ANSWERS TASK 11

## 1a. Identify the reason for the Habitat for Humanity project.

To build safe, decent, affordable housing for underprivileged families living on the 'Peace Line' between Templemore Avenue and the Short Strand in East Belfast.

## 1b. Name two ways in which the apprentices benefited from their work on the project.

1. It provided an insight into the different aspects of construction and how trades interlink and rely on each other.

## 2. They got the opportunity to practice the skills taught in College.

ectly linked to the speed at which an underprivileged family would receive their new home from Habitat for Humanity.

## 2a. Identify two words or phrases used by the writer to describe the families in need of shelter.

Word/Phrase 1. Underprivileged

Word/Phrase 2. "People less fortunate than us"

## 2b. Suggest a reason why the writer has used these words/phrases.

1. The writer is using emotive language to appeal to the emotions of the reader. The reader feels sad that people are living in deprived conditions.

## 3a. Give an example of where opinion is presented as fact.

"The day was a great insight into the 'real world' for some of our Apprentices."

## 3b. The writer describes the experience of the apprentices as "fantastic" and "satisfying." Say why the writer uses this style of language. In other words what effect do these words have on the reader?

These words are positive and uplifting. The writer is using emotive language to engage the reader in these positive feelings towards the work carried out by the apprentices and the benefits to the underprivileged families.

## 4. Explain in your own words how the photograph of the apprentices supports the view of the writer.

The writer of the article has very positive views of the work of the apprentices. The message put forward by the article is that this has been a positive and uplifting experience. The photograph of the apprentices supports this view. The apprentices are shown to be proudly displaying the Habitat for Humanity banner – this reflects their pride in the work they have just carried out. The banner uses the persuasive technique of repetition i.e. "Building Houses, Building Community, Building Hope" to support the view that the work of Habitat for Humanity is vital.

# READING ANSWERS TASK 11

## **5. Imagine you are going to give a short talk in support of the Habitat for Humanity project. Using information from the article:**

### **5a. Summarise two arguments you would use to support your view.**

#### Argument 1

Habitat for Humanity is vital work because it provides decent safe affordable homes for people in deprived living conditions.

#### Argument 2

Apprentices get the opportunity to practice the skills they have learned at college.

### **5b. Explain why you might use these arguments in your talk. (Persuade, convince listeners etc)**

#### Argument 1

I would use this argument to persuade the listeners of the importance of the work carried out by Habitat for Humanity.

#### Argument 2

I would use this argument to convince listeners of the benefits of the scheme for apprentices who will have the opportunity practice their skills while helping underprivileged families.

## **6. Using the article identify and explain three techniques used by the writer to support his/her views.**

### Technique 1 and explanation:

The writer uses the 'list of three' adjectives "safe, decent, affordable" to describe the new housing built by the students. This is a persuasive technique used by the writer to help drive the message home that these homes are built with care for families who cannot afford expensive houses.

### Technique 2 and explanation:

In the second last paragraph the writer presents opinion as if it was fact i.e. "The day was a great insight into the 'real world' for some of our Apprentices." This is a persuasive technique used to convince the reader of benefits to the students taking part in the scheme.

### Technique 3 and explanation:

The writer uses emotive vocabulary to engage the emotions of the reader e.g.

- "deprived" "underprivileged" to describe the situation of the families needing re-homed.
- "extremely beneficial" "fantastic experience" to describe the experience of the apprentices.
- "safe" "decent" "affordable" to describe the shelter provided to underprivileged families



# Writing Tasks and Answers



# WRITING TASK 1

## SENTENCES

Sentences are groups of words that make complete sense. When writing you will need to check that your sentences are complete.

**Example 1.** 'Internal finishes are a matter of...' does not make a complete statement and is not a proper sentence.

**Example 2.** 'Internal finishes are a matter of personal taste.' This makes a complete statement and is a sentence. Every word counts.

### Activity 1

Which of these groups of words is a complete sentence? Circle complete or incomplete as appropriate. Rewrite the incomplete sentences, using the beginnings or endings below, to make complete sentences.

### Activity 2

#### BEGINNINGS

When applying a finish ...  
 There are two types of finish...  
 A problem with wet finishes...  
 Plaster board, timber panelling and carpet  
 There are two basic methods of ...  
 Sand and cement mixture ...  
 Primer is useful for ...  
 The colour of the undercoat should be an appropriate shade to match ...  
 Normally two coats of undercoat ...  
 The finishing coat ...

#### ENDINGS

... must be to the highest level.  
 ... expansion or shrinkage of the timber components of the build.  
 ... preserve it, to improve its appearance and for reasons of hygiene.  
 ... of the material and evens out the surface.

# WRITING TASK 1

**1. Internal finishes must be carried out in the proper sequence.**

Complete / incomplete

**2. It is essential that care is taken to avoid damage once a finish is applied.**

Complete / incomplete

**3. The standard of workmanship must be to the highest level.**

Complete / incomplete

**4. When applying a finish it is important that the background is perfectly dry.**

Complete / incomplete



# WRITING TASK 1

**5. When considering which finish to use, it is important to think about how the building is going to be used and the wear, tear and maintenance of the building.**

Complete / incomplete

**6. There are two types of finish; self finish and applied finish.**

Complete / incomplete

**7. Types of wet finishes are plaster, paint and wallpaper.**

Complete / incomplete

**8. A problem with wet finishes is the amount of time it takes to dry out.**

Complete / incomplete

**9. Wet finishes may cause expansion or shrinkage of the timber components of the build.**

Complete / incomplete



# WRITING TASK 1

**10. Plaster board, timber panelling and carpet are all examples of dry finishes.**

Complete / incomplete

**11. Dry finishes cause no shrinkage and do not prevent occupancy of the building.**

Complete / incomplete

**12. Self finish is inherent in the material and does not need to be applied on.**

Complete / incomplete

**13. Natural stone, facing brick, natural slate and natural wood are all types of self finishes.**

Complete / incomplete

**14. There are two basic methods of carrying out internal plastering.**

Complete / incomplete

# WRITING TASK 1

- 15. The most popular method of applying internal plastering is to apply one or two coats of sand and cement on block or brick walls followed by a coat of gypsum plaster.**

Complete / incomplete

- 16. Another method of applying internal plastering is to use a lightweight gypsum undercoat followed by a finish coat of gypsum plaster.**

Complete / incomplete

- 17. Sand and cement takes longer and is harder to apply than lightweight gypsum undercoat.**

Complete / incomplete

- 18. Sand and cement mixture is much more hard wearing.**

Complete / incomplete

# WRITING TASK 1

**19. Lightweight gypsum undercoat is used where good thermal insulation properties are needed.**

Complete / incomplete

**20. Painting is used in buildings to preserve it, to improve its appearance and for reasons of hygiene.**

Complete / incomplete

**21. When completing a painting job a primer is used first, followed by an undercoat and ending with a finish coat.**

Complete / incomplete

**22. The correct primer must be used depending on the material to be covered.**

Complete / incomplete

# WRITING TASK 1

**23. Primer sticks to surface of the material and evens out the surface.**

Complete / incomplete

**24. Primer is useful for controlling rust.**

Complete / incomplete

**25. Primer provides a good surface for the undercoat to adhere to.**

Complete / incomplete

**26. Undercoat helps to even out an irregular surface.**

Complete / incomplete

# WRITING TASK 1

**27. The colour of the undercoat should be an appropriate shade to match the colour of the finishing coat.**

Complete / incomplete

**28. Normally two coats of undercoat are needed to reach the proper standard.**

Complete / incomplete

**29. The finishing coat adheres to the undercoat and gives a protective layer, the desired colour and outer texture.**

Complete / incomplete

# WRITING TASK 2

## SIMPLE, COMPOUND AND COMPLEX SENTENCES

When we write we use a variety of sentences to make our writing more interesting and engaging to the reader.

### Simple Sentences

A simple sentence expresses a complete thought and contains a subject and a verb.

**Joe** is plastering the wall

**Subject**

Joe is **plastering** the wall

**Verb**

### Compound Sentences

A compound sentence is made up of two complete simple sentences joined by a conjunction such as and, but, so, for.

Joe is plastering the wall **and** Bill is painting the top floor windows.

**Conjunction**

### Complex Sentences

A complex sentence has a complete sentence with a complete thought. It has a subject and a verb – but it adds additional information. The additional information is given in phrases that tell you more about the complete sentence. The phrases cannot stand on their own. The information in the complete sentence part is more important than the additional phrase/s.

Joe is plastering the wall and, **although he is terrified of heights,** Bill is painting the top floor windows.

**Additional phrase  
- is not a complete  
thought - less  
important part  
of sentence**

# WRITING TASK 2

## Activity

Which of the following are simple, compound or complex sentences.

**1. Scaffolding is a temporary structure.**

**2. Scaffolding should only be erected, altered and dismantled by a trained scaffolder.**

**3. Unless a construction worker is properly trained, he/she cannot use a scaffold.**

**4. Before using a scaffold, you must read the official publications that contain the regulations for safe use of scaffolding.**

# WRITING TASK 3

## PUNCTUATION

Punctuation is important because it helps the reader to understand what you have written.

There are four types of sentence. Sentences all begin with a capital letter but they do not all end the same way.

- Statements: e.g. Copper pipe is the most popular type of piping used in domestic hot and cold water systems .

Full Stop

- Questions: Is copper is a good conductor of heat ?

Question Mark

- Exclamations: Lead poisons water !

Exclamation Mark

- Commands: Do not install black iron pipe !

Full stop or exclamation mark can be used here.

A sentence needs to make complete sense and needs to include a verb.

This is a sentence:

**“Bricks are probably the oldest manufactured material we have today.”**

Verb

This is incomplete and does not contain a verb. It is not a sentence.

**“The method of producing bricks”**



# WRITING TASK 3

## Activity 1

Read the following sentences and add the correct capital letters and punctuation to each.

**1. The method of producing bricks has changed since they were first used in building**

**2. How do I reduce my carbon footprint**

**3. do bricks have many advantages over other types of building materials**

**4. NEVER use power tools near flammable substances**

# WRITING TASK 3

## 5. What are the main benefits of home insulation

## 6. The majority of staircases used in domestic construction are made from solid timber

### Activity 2

## Comma ,

We use commas are used to break up sentences into orderly chunks.

**Commas are used to separate items in a list, e.g.**

The Department of the Environment (DOE) sets out areas in each town for housing , industry, hospitals, schools **and** other amenities.

**A comma separates each item**

**The Last two items on the list are linked by 'and' - no commas are needed.**

**Commas separate out additional information that has been added into a sentence e.g.**

The Planning Service, **after consultation with Local Borough Councils**, may decide to designate areas of towns or villages as Conservation Areas.

(\*Try reading the sentence above without the highlighted phase. You will find the sentence reads perfectly well without it!)

**A comma is used to separate clauses.**

**A clause is a main part of a sentence and each clause must have a verb e.g.**

**Unless it is a replacement dwelling , building is not encouraged in the countryside.**

**Clause with verb 'is'**

**Clause with verb phrase 'is not.'**

## WRITING TASK 3

Rewrite the following sentences putting commas in the correct places.

**1. To improve the quality of our environment the Department for the Environment provides Area Plans for our towns and villages.**

**2. The Planning Department prepares an Area Plan for all towns which consists of diagrams illustrations maps and written information.**

**3. Unless new development plans fit in with the Area Plan they may not be passed.**

## WRITING TASK 3

**4. If it has a good reason the department can alter a development plan.**

**5. The department can alter a development plan at any time if a good reason is given.**

**6. Northern Ireland's planning policy "Sustainable Development in the Countryside" will apply a policy similar to Greenbelt policy to the whole of Northern Ireland.**

## WRITING TASK 3

**7. The only types of buildings that are encouraged in the countryside are replacement dwellings farm workers dwellings and retirement dwellings for farmers.**

**8. Any new dwellings built must integrate into the countryside be of an approved design and reflect the area in which it is situated.**

**9. Building design in conservation areas including size of buildings brickwork doors and windows will be restricted.**

## WRITING TASK 3

**10. Area Plans will provide protection for interesting buildings such as those of architectural interest historic interest and areas of special character and appearance.**

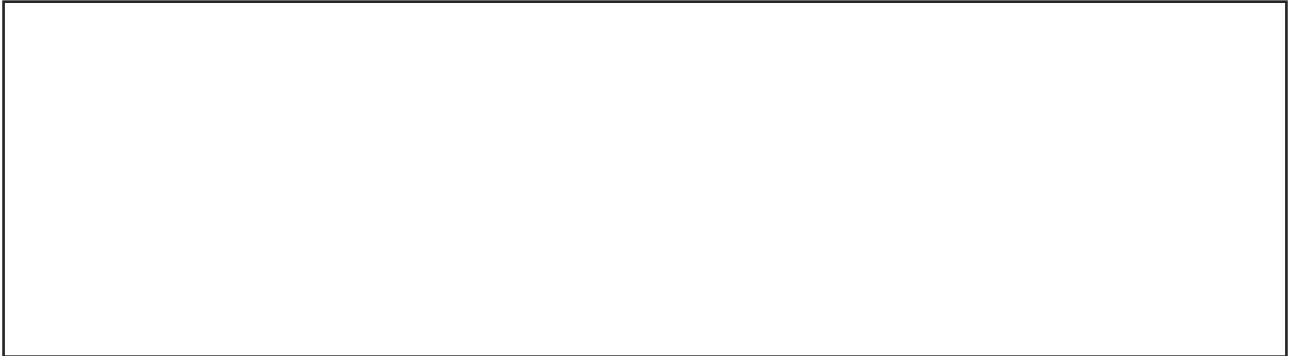

**11. To preserve and enhance special places they are protected as Conservation Areas.**



**12. The Moravian village of Gracehill outside Ballymena is one of the best preserved villages of its kind in Western Europe.**



# WRITING TASK 3

## Activity 3

### Colon :

Use a colon before giving an example or an explanation of what has gone before, a list or a quotation.

**There are various types of air pollution : acid rain, photochemical smog, atmospheric gasses.**

Rewrite the sentences below putting the colon in its proper place.

- 1. The vacancy advert in the paper suits me it's looking for someone with experience in fitting kitchens.**

- 2. Construction site safety signs are vital they are a constant reminder of the hazards in the workplace.**

## WRITING TASK 3

**3. Instruction leaflets are useful they save time and money when planning a DIY job.**

**4. Peter made a list of the tools he needed to erect the fence protective gloves, long tape measure, spade, 2 builders' lines, panel saw, power drill with twist and wood bits, club hammer, spirit level, trowel, hammer, canes.**



# WRITING TASK 3

## Activity 4

### Semi-colon ;

Use a semi-colon to separate two related sentences.

#### Example

**The construction industry accounts for 25% of all injury accidents ; more than 20% of these accidents occur when manually lifting equipment and materials.**

Insert semi-colons into the following sentences.

- 1. Ladders are not always the best equipment for the job a mobile tower, Air Port Steps or scaffolding may suit better.**

- 2. There can be no short cuts on safe practice inspect your ladder regularly.**

## WRITING TASK 3

- 3. Some jobs will require the use of an extension ladder always make sure you extend it before climbing.**

- 4. You will need to secure the bottom and the top of the ladder you do this by tying it to the stiles (not the rungs)**

# WRITING TASK 3

## Activity 5

### Brackets ( ) and Dashes -

Brackets and dashes can be used to separate out extra information from the main part of the sentence or statement. Either works equally well.

Example

- 1. Protective clothing (especially leather or PVC gloves) should be worn to protect the hands from sharp or jagged edges.**
- 2. Protective clothing - especially leather or PVC gloves - should be worn to protect the hands from sharp or jagged edges.**

Now try these. Rewrite the sentences below twice – once using brackets and the second time using dashes.

- 1. Sprains and strains to muscles joints, ligaments, tendons, disc trouble and hernias are often caused by sudden awkward movements while lifting.**

- 2. When I first started work with Renovations Workshops at the beginning of my apprenticeship I was given an induction talk and had training in Health and Safety.**

## WRITING TASK 3

**3. When taking nails from old rafters or beams if this is required I use a metal detector to find nails that cannot be seen.**

**4. The company is specialises in selling sash windows and their boxes mainly trading in the Waterford area but also carries out other renovation work on period houses.**

# WRITING TASK 3

## Activity 6

### Speech Marks “ ”

Speech marks are used to show the exact words spoken.

**Tom said, “The new build is starting next week.”**

**Put speech marks in the correct places within these sentences.**

- 1. The driver asked Jack where do I leave the supplies?**
- 2. Have you completed your training on Health and Safety legislation the tutor asked the group?**
- 3. Did Joe pass on the memo to you the receptionist asked?**
- 4. Frank said we finish tomorrow for our holidays.**

# WRITING TASK 3

## Inverted Comas

We use inverted commas when:

- Quoting what someone has said or written, e.g. The newspaper article stated that “Global temperatures are continuing to rise.”
- Giving the title of newspaper, book, film or play, e.g. Peter Brett’s book “A Building Foundation Craft Foundation” is used by construction students throughout the UK.
- When using slang or when words are used in a particular way e.g. He thought the group was “real cool.”

Insert inverted commas into the following sentences.

1. **Environmental correspondent, Richard Black (BBC News website) in his article Big profit from nature protection says that “money ploughed into protecting wetlands, coral reefs and forests can bring a hundredfold return on capital.”**
2. **Tom thought his manager was a bit of a jobs worth until he realised that the rules were legal requirements that kept him and his colleagues safe.**
3. **The title of Peter’s assignment was “Health and Safety Policies improve safety on site”**

# WRITING TASK 4

## APOSTROPHES

### Apostrophe or Plural?

Most mistakes with apostrophes are made using plurals. Plural just means more than one. You would not use an apostrophe with a plural, e.g.

We offer discount on larger orders<sup>s</sup>.

More than one order so it is plural. No apostrophe is used.

Joiners<sup>s</sup> should look after their tools.

More than one joiner so this is plural. No apostrophe is needed.

Great sale on chart CDs<sup>s</sup>.

Plural again - no need for an apostrophe.

### Activity 1

In the following sentences apostrophes have been used for plurals. Rewrite the sentences correctly.

1. 'Belfast Building Supplies for cheaper brick's!'

2. Stepladder's are one of the most important pieces of equipment in the construction industry.

## WRITING TASK 4

**3. In some types of construction rooms are know as cell's.**



**4. Bricks are produced to withstand heavy load's.**



**5. The ceiling joist's are only 100mm deep.**





## WRITING TASK 4

**6. Stair's should be safe.**

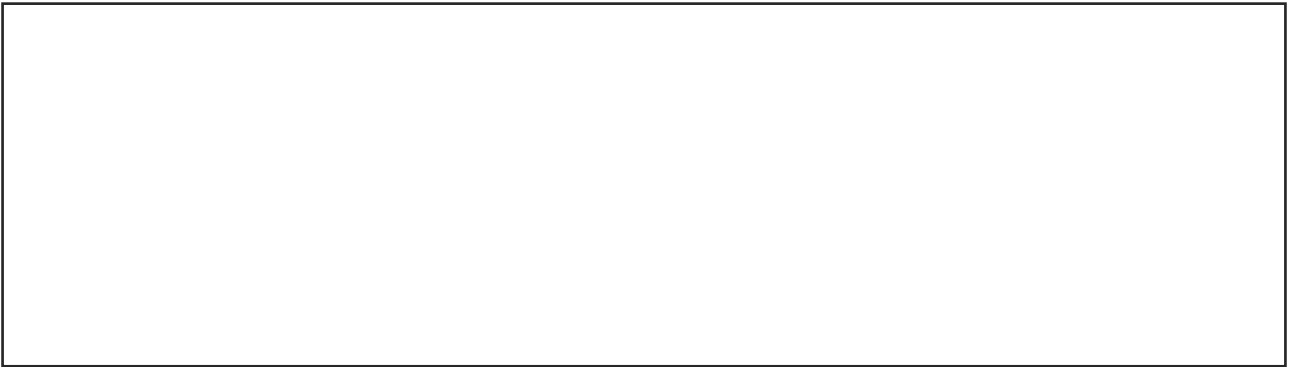

**7. Employer's must make sure equipment is safe.**



**8. Window's are available in different shape's, size's and material's.**



# WRITING TASK 4

## POSSESSION

Apostrophes are used to show ownership  
's is added to the word that shows who the owner is.

The carpenter's hand drill.

The Hand drill belongs to the carpenter 's

The plumber's van

The van belongs to the plumber so 's

The safety officer's inspection

The inspection was carried out by the safety officer so 's

### Activity 2

The sentences below all have single owners. Rewrite using an apostrophe to show ownership.

The joiners last job took him four days to complete.

The ladders rung was broken.

The builders square is useful for cutting plywood.

When there is more than one owner and the noun ends in 's' add an apostrophe after the 's' e.g.

The customers' property

The clients' wishes

When a noun ends in 's' you can add 's or just ' e.g.

Thomas's plane

Charles' drill.

# WRITING TASK 4

## OMISSION

Apostrophes are used when letters are missing.

### Contractions

The apostrophe is used when writing contractions. Contractions are shortened forms of words from which letters are missing. We mainly use contractions in speech or in informal texts.

We shorten a word or phrase and then use an apostrophe to show where the letters are missing from.

Here are some familiar examples

COMPLETE WORD / PHRASE	MISSING LETTERS	SHORTENED FORM
do not	o	don't
Will not		won't
are not	o	aren't
was not	o	wasn't
would not	o	wouldn't
I am	a	I'm
I will	wi	I'll
you are	a	you're
it is	i	it's
it has	ha	it's
what is	i	what's
let us	u	let's
that is	i	that's
you would	woul	you'd
your are	a	you're
can not	no	can't
could not	o	couldn't
they are	a	they're
they had	ha	they'd
that is my hammer.	i	that's my hammer.

Irregular - does not work neatly

# WRITING TASK 4

Often the following are mixed up. If you say the words in full you should not get mixed up.

## There / their / they're

**They're** sounds like **there** (a place) and **their** (belonging to them). It is short for **they are**.

## You're / your

**Your** means belonging to you.

**You're** is a short for **you are**.

## It's / its

**It's** is short for **it is** or **it has**.

**Its** means belonging to it.

# WRITING TASK 4

## Activity 3

Rewrite sentences 1, 2 and 3 below changing the bolded words into contractions using an apostrophe.

1. **They are** throwing a party when the new build is complete.

2. **You are** the best candidate for the job.

3. **It is** important to use the proper tools for the job.

4. Now write a sentence containing its and one containing it's.

## WRITING TASK 4

Read through the email below. It contains a number of contractions. Underline or highlight the contractions in the text then rewrite the email message using the words written in full. Does the rewritten message sound more formal?

### Email

**To... hcurran@abc.com**

**CC...**

**Subject: Saturday Job!**

Hi Hadyn

I haven't had a minute since I last saw you. How's the new job going? Hope you're not working too hard! I'm making a start on the conservatory next Saturday and I was wondering if you'd be interested in some weekend work.

Everything's worked out well and all the materials have been delivered already so we're ready to rock! I've just spoken to Barry and he's said he can give us a hand with the electrics.

You wouldn't, by any chance, have Adam's mobile number? I'm hoping he'll tip in as well because it's hard to beat a good team!

Let me know anyway and I'll see you soon.

Rory

# WRITING TASK 4

**To... hcurran@abc.com**  
**cc...**  
**Subject: Saturday Job!**

# WRITING TASK 5

## SUBJECT VERB AGREEMENT

Verbs and subjects must agree. Rewrite the sentences using the correct verb form so that it agrees with its subject.

(Remember: Verbs are action words and the subject is who or what is doing the action)

**1. The Health and Safety at Work (Northern Ireland) Order require/ requires that employers must provide a safe place of work.**

**2. Employers must provide equipment that are/is suitable for the job.**

**3. Four main types of ladders is/are used in the construction industry.**



## WRITING TASK 5

**4. Standing ladders have/has rectangular or round stiles.**

**5. The wooden ladders was/were made from Douglas fir.**

**6. The aluminium ladder was/were easier to carry.**

# WRITING TASK 6

## VERB TENSES

A verb indicates when an action takes place. It can be the past, present or the future.

PAST	PRESENT	FUTURE
In 2008 I worked for Builders NI LTD	I am working for Design Workshops	Next year I shall own my own business.

When using verbs you need to think whether the sentence is referring to the past, present or future.

Remember to keep the verb tense consistent when discussing the same event.

### Verb Tenses

#### Activity

Read the following report on a workplace accident and chose the correct verb tense for the report.

John Briars and his supervisor Phillip Reid, **were / are / will be** employees of Adams Building Contractors, a Northern Ireland building and construction company.

They **were / are / will be** replacing house windows at number 42, Beach View Estate in Holywood, and had just **started / start / will** start back to work after lunch at 2pm.

John **rested / rest / will rest** a ladder on some grass. The ground **looked / look / will** look fairly stable even though it **was / is / will be** sloping slightly away from the building. He did not tie the ladder or secure it by any other means.

Phillip had gone inside the building to collect some tools and so **was / is / will** be not there to foot the ladder.

John began carrying some silicon sealant up the ladder for the new window. When he had **reached / reach / will reach** a height of about 3m the bottom of the ladder **slipped / slip / will slip** out and he fell. John **fractured / fracture / will fracture** his leg badly.

# WRITING TASK 7

## SPELLING HOMOPHONES

Homophones are words that sound the same but are spelled differently and have different meanings. Many homophones, such as the ones below, are used very often so it is important that you learn how to spell them.

Rewrite the sentences below using the correct homophone. Then write a sentence of your own containing each of the homophones.

### 1. Are, Our and Hour

**Are** is part of the verb to be – e.g. ‘We **are** plumbers’ – ‘they **are** carpenters’– ‘you **are** a plasterer’  
‘Timber framed houses **are** normally made in factories’

**Our** means belonging to us e.g. ‘**Our** new contract begins in October.’

**Hour** means the time on the clock e.g. ‘The delivery should have been here an **hour** ago.’

**a. Windows ( are / our / hour ) available in a variety of designs, shapes, sizes and materials.**

**b. ( Hour / our / are ) course tutor is a stickler on Health and Safety issues.**

**c. We practice bench joinery construction in ( are / our / hour ) workshop at college.**

## WRITING TASK 7

**d. Vertical sliding sash windows ( hour / are / our ) often used in Georgian Architecture.**

**e. Windows ( our / hour / are ) often part of the external cladding of an office building.**

**f. Often there ( our / are/ hour ) several different types of roof in one building.**

**g. The majority of staircases used in domestic construction ( hour / our / are ) made from solid timber.**

**h. ( Hour / our / are ) group had a three ( are / our / hour ) risk assessment training on Tuesday.**

## WRITING TASK 7

**i. Always ensure that roof coverings (hour / our / are) in harmony with the local environment and that they are fit for purpose.**

**j. (Hour / our / are) new workshop is well equipped.**

### **2. They're / their / there**

**They're** - they are - They are planning to build

**There** - 1) - a place e.g. over there 2) Used with is, are, were, was.

**Their** - belonging to them their workshop

Rewrite the following sentences using the correct homophone.

**a. ( They're / there / their ) planning to start the new build in May.**

**b. A private staircase serves one dwelling. ( They are / their / there ) normally manufactured in a workshop to specific dimensions.**

## WRITING TASK 7

**c. Most modern windows are casement windows. ( They're / their / there ) hinges are placed on the side to allow them to swing open vertically, like a door.**

**d. ( Their there they're ) site plans gave the position of the proposed dwelling.**

**e. Bench joiners use ( they're / their / there ) portable power tools more often than their hand tools, but ( they're / there / their ) both important.**

**f. Chisels work best when ( there / their / they're ) very sharp.**

**g. When using hand tools ( their / there / they're ) can be danger of injury from fast-flying objects.**

# WRITING TASK 7

## 3. Where / were / wear / we're

**Where** - a place - **Where** is the site?

**Were** - past tense - We **were** planning to build.

**We're** - short for 'we are'. **We're** the proud owners of two Vauxhall Astravans.

**Wear** - to be clothed in - I **wear** protective headgear on site. Or to wear out something by using it a lot.

- a. On the construction site, it is important to ( were / where / we're / wear ) safety hats and footwear to protect from falling objects.

- b. It is important to ( where / wear / we're / were ) high visibility vests to let others see exactly ( where / wear / we're / were ) you are.

- c. ( Wear / we're / were / where ) all agreed that ( we're / where / wear / were ) Health and Safety are concerned, it's better to be safe than sorry.

## WRITING TASK 7

**d. Robert knew how important it was to know exactly ( wear / where / we're / were ) all his equipment was.**

**e. If you are using hand tools it is vital to ( where / wear / we're / were ) the correct Personal Protective Equipment (PPE) for the task.**

**f. It is important to know when and ( were / where / wear / we're ) to use particular hand tools.**

**g. We need to maintain tools to protect them from ( we're / where / wear / were ) and tear.**



## WRITING TASK 7

**h. Never ( where / were / wear / we're ) loose clothing or jewelry when working with hand tools as they could catch on the tools.**

### **4. Who's or Whose?**

**Who's** - means 'who is'

**Whose** - means belonging to whom

**a. Make sure you know ( who's / whose ) job it is to carry out a risk assessment on the electrical wiring job.**

**b. "( Who's / whose ) the new supervisor at the Timber Stores?"**

## WRITING TASK 7

**c. “( Who’s / whose ) hammer is this?”**

**d. ( Who’s / Whose ) name is on this kit?**

### **5. To / Two / Too**

**To** - towards - ‘I am going to the suppliers later.’

**Two** - the number 2

**Too** - as well as - or also - or ‘over the top’ - ‘too much’

**a. The joiners knew that if they accepted another job they would have ( to / two / too ) much work on to be able to complete on time.**

**b. Most garages are (to / two / too) small for modern cars.**

## WRITING TASK 7

**c. Disruption ( to / two / too ) to your home life can be kept ( to / two / too ) a minimum for most garage or loft conversions.**

**d. The job would take ( to / too / two ) hours at the most.**

# WRITING TASK 8

## PARAGRAPHS

Look at any piece of writing – a newspaper article, a letter, a book or a magazine – and you will see that the text is divided into paragraphs. Dividing the text into paragraphs makes it easier to read and follow. Each paragraph in a text deals with an aspect of the topic you are writing about.

### Activity 1

- a. Read each of the paragraphs below then write the topic of the paragraph in a word or phrase.
- b. One sentence in each paragraph does not fit in. Write out the sentence that does not belong.
- c. Say why it doesn't fit in.

**1. When I first became an apprentice with Restoration Workshops I was given an induction course on Health and Safety and fire awareness training. I was trained to use Personal Protective Equipment (PPE) and learned when and where I should wear protective clothing. There was a great canteen there as well. I had training on how to work safely with machinery and how to go about making a risk assessment. There were also a number of fire drills to make so I knew what to do in the event of a fire.**

a. Paragraph Topic:

b. Sentence that does not fit in:

c. Sentence does not belong because:

## WRITING TASK 8

**2. The government is directing us to insulate building walls in an attempt to reduce greenhouse gas emissions. The more energy we use to heat our homes the more greenhouse gases we add to the atmosphere. Northern Ireland MP Sammy Wilson believes that man-made global warming is a con. The government's Building Regulations is directing us to increase the amount of insulation within the walls of our homes and factories. To achieve this, cavity walls are built to hold 60mm thick insulation and double glazed windows are sealed to prevent heat loss.**

a. Paragraph Topic:

b. Sentence that does not fit in:

c. Sentence does not belong because:

## WRITING TASK 8

**3. More than 70% of people living in the United States and the United Kingdom live in timber framed houses. The internal structure of a timber frame house is a wooden frame which is then covered by brick or stone to provide the external finish. The reason timber framed homes are so popular is because they are quick and easy to assemble. The builder can buy a timber framed structure as a kit with all of the pieces cut to measure and ready to assemble. I was always good with jigsaw puzzles and mechano sets when I was a child. Timber framed dwellings can be assembled much quicker than houses made from brick and block. A timber framed dwelling can be erected in two or three days and is ready for roofing, windows and plumbing etc within two weeks.**

a. Paragraph Topic:

b. Sentence that does not fit in:

c. Sentence does not belong because:

## WRITING TASK 8

**4. Adding space to your home can add thousands of pounds to its value. There are a number of ways you can do this including adding an extension or converting your loft, cellar or garage. My neighbour says he would rather move house rather than have all the hassle of renovation. There are advantages and disadvantages to adding extensions or doing conversions (for example a ground floor extension will mean a smaller garden) so it is always important to have a workable plan in place before you start.**

a. Paragraph Topic:

b. Sentence that does not fit in:

c. Sentence does not belong because:

## WRITING TASK 8

**5. The Titanic Quarter in Belfast is being redeveloped by the Port of Belfast and Titanic Quarter Limited. The area was once the site of the Harland and Wolff shipyard from which the RMS Titanic was launched on 10th April 2010 only to strike an ice-burg and sink four days later with a loss of 1522 of its 2,200 passengers and crew. Leonardo de Caprio and Kate Winslett starred in the classic film Titanic in 1997. The site is 185-acres on the banks of the River Lagan. The redevelopment is expected to cost £56 billion pounds, create 25,000 new jobs and will take around 15 years to complete.**

a. Paragraph Topic:

b. Sentence that does not fit in:

c. Sentence does not belong because:



# WRITING TASK 8

## Activity 2

### PARAGRAPH WRITING

The following sentences introduce the topic of the paragraph. Complete the paragraphs.

1. It is better to improve your home than to go through all the hassle of moving.
2. Homes can be affordable and environmentally friendly.
3. Over a third of injuries lasting more than three days are caused by manual handling.
4. Timber framed houses are quicker and easier to build than brick or stone.
5. If you are going to buy a listed building then you will need to plan, plan and then plan again.
6. The Health and Safety at Work Regulations apply to everyone.
7. Scaffolding is an important piece of equipment on the construction site.
8. Care must be taken when using electrical equipment.
9. At 828m high the Burj Khalifa in Dubai, United Arab Emirates is the tallest building in the world.
10. It is important to know where your wood products come from.
11. Copper pipe is used in most types of domestic hot and cold water systems and is used in domestic central heating systems.
12. Risk assessment is always the first thing to consider when planning a construction job.

# WRITING TASK 8

## Activity 3

### Paragraph Writing

**Divide the following text into five paragraphs. Rewrite the text using paragraphs for each new section. Remember to think about where one topic ends and another begins.**

Local stone was once the traditional choice when constructing dwellings and industrial buildings. Stone walls were generally very thick and had no damp proofing. Smaller stones were inter spaced with the larger ones and were bound together with lime mortar. More recently stone walls have been built with sand and cement. The red brick terrace houses built in close proximity to mills during the industrial revolution were built one-brick thick. They were cheaply constructed using bricks that were made locally and English Bond to form a solid wall. A problem with one-brick wall construction was that moisture travelled from the outside causing damp patches on the inside of the building. Cavity wall construction was developed to prevent the spread of damp into the inside of the buildings. Cavity walls are two walls with a space between. Moisture could not travel from the outside of the building to the inside. It also helps to keep in heat. Energy loss needs to be reduced further so existing cavity wall insulation will need to be improved even more if a reduction in heat loss is to be achieved. Timber framed walls differ from those constructed of traditional brick and block work because the structure is composed of wood. Timber framed structures must comply with every aspect of the building regulations including fire resistance. Curtain wall construction is used for commercial and industrial structures. Curtain wall structures have infill panels of glass or opaque materials. They often have an inner wall consisting of block.

1.

# WRITING TASK 8

2.

3.

# WRITING TASK 8

4.

5.

# WRITING TASK 9

## MIND MAPPING

### Sixty Minute Makeover

#### Task

**You have been offered the chance to have a thirty minute makeover on your home /or a flat that you are renting/buying. The makeover team can change three areas for you. Select three areas you would like changed and use the mind map below to explore your ideas on:**

- How things are at the present
- How you would like your home/flat to look when the makeover team have finished.

When planning a project/essay/article etc always mind map your ideas.

Mind mapping is a process whereby we start with a topic and explore ideas the way our mind would. It is an excellent way of gathering ideas and recording them until they are needed.

For example if we start with the topic 'HOUSE' we begin by thinking of the different rooms etc. This is how our thinking might look.

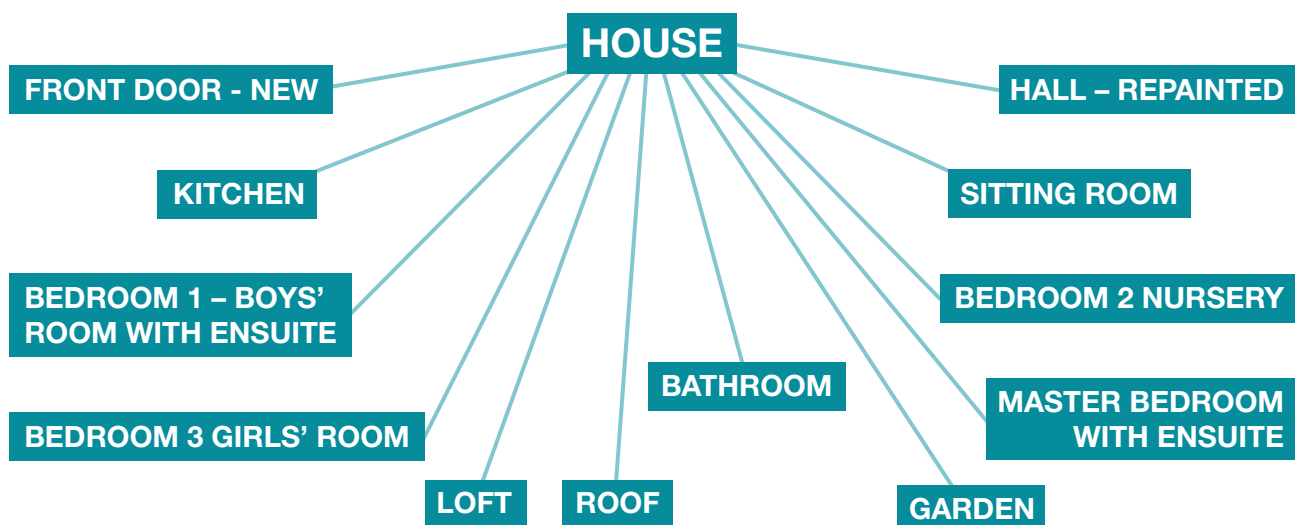

# WRITING TASK 9

## **Sixty Minute Makeover**

Next look at how you might describe how these rooms look at the moment. Take them one at a time. For example, how would you describe the hallway?

Think Hallway

Is there a colour scheme? What is it?

How is it decorated? Is there a coat rail? Or a mirror? Or a plant?

Is the hallway well lit - or not? Think why or why not e.g. does the front door have glass panes to allow in light?

Are the walls papered or painted?

Is the floor carpeted or wooden with a runner?

What effect does this have?

What would you like to change? What, if anything, would you like to keep?

**You can repeat the process for each of the rooms.**

# WRITING TASK 10

## STRUCTURING AN EXTENDED TEXT - RISK ASSESSMENT REPORT - EXCAVATION

Using the mind map provided write a report of 500 words or more on the risk assessment process when planning excavations.

### Remember to include:

- **Title** - Your title should be a word, phrase or short sentence that tells the reader what the report is about.
- **Introduction** - first paragraph - where you outline the purpose of your report and say what it will be about.
- **Subheadings** - to highlight clearly for your reader what the paragraph is about.
- **Paragraphing** - to separate your points.
- **Conclusion** - final paragraph - you might want to state the importance of following risk assessment procedures.

You will want to mention excavation dangers such as those listed below.

1. **Collapse of excavation**
2. **Contact with buried services**
3. **Ingress of water**
4. **Build up of fumes**
5. **Being struck by falling materials**
6. **Contact of overhead lines by diggers etc**
7. **Effect on nearby structures**
8. **Confined space implications**

# WRITING TASK 10

## EXCAVATIONS

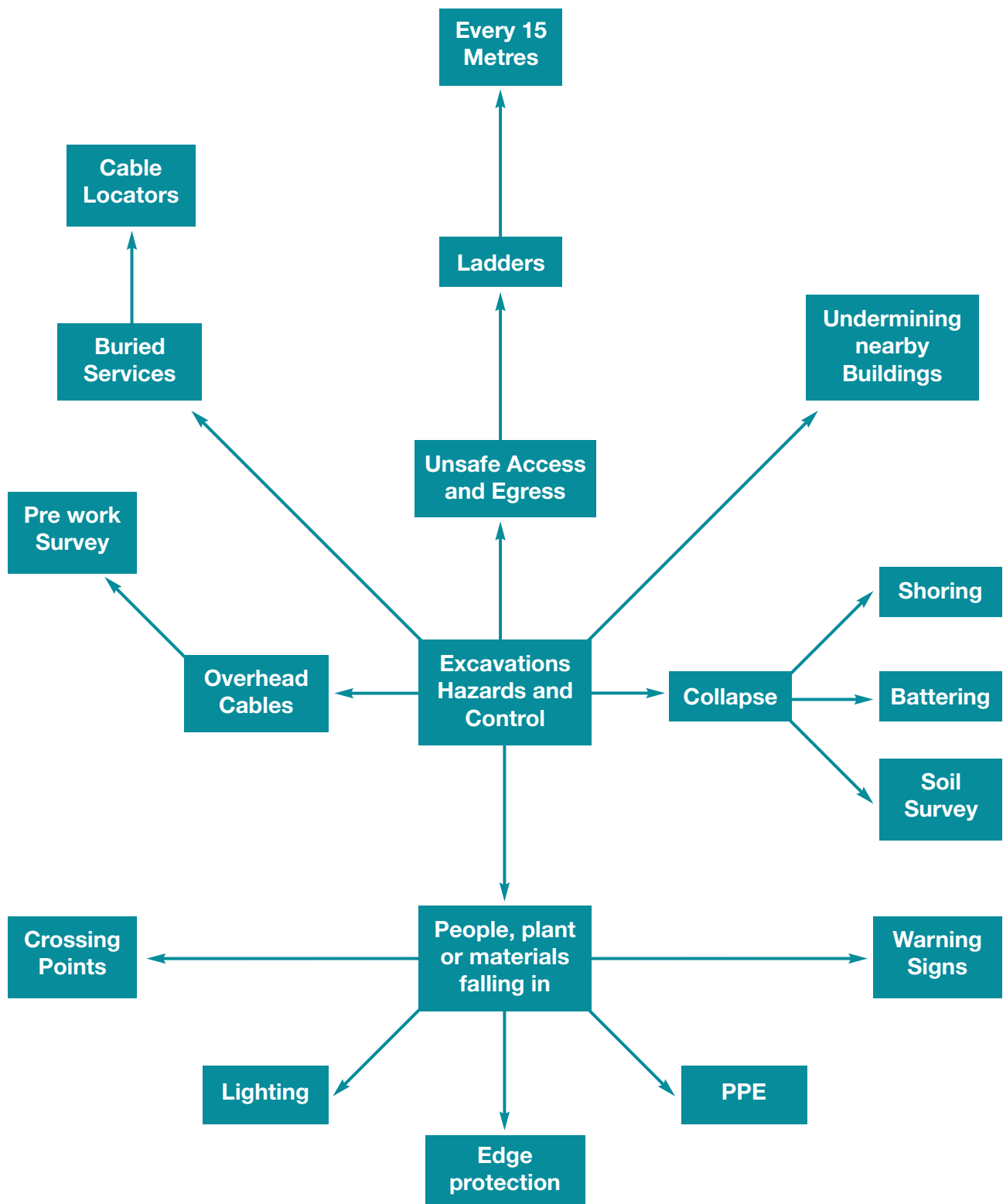



# WRITING TASK 11

## PROOF READING AND REVISE WRITING FOR ACCURACY AND MEANING

### WRITING CHECKLIST

EDITING CHECKLIST	TICK
Appropriate format is used depending on the audience and purpose of the text e.g.	
<ul style="list-style-type: none"> <li>• formal letter</li> <li>• email</li> <li>• report</li> <li>• informal letter</li> <li>• memo</li> <li>• college assignment</li> </ul>	
Language is appropriate for audience and purpose e.g. <ul style="list-style-type: none"> <li>• Formal</li> <li>• Informal</li> <li>• Mixture of both (as in some advertising)</li> </ul>	
Appropriate style is used for the text where required e.g. <ul style="list-style-type: none"> <li>• Persuasive techniques when writing an argument</li> </ul>	
Appropriate structure is used e.g. <ul style="list-style-type: none"> <li>• Title</li> <li>• Paragraphs used to sequence ideas or information</li> </ul>	
Written text is appropriate length e.g. <ul style="list-style-type: none"> <li>• One of the L2 texts for your project needs to be a minimum of 500 words.</li> </ul>	
All relevant detail is included.	
Grammar: <ul style="list-style-type: none"> <li>• Use of verbs (doing words)</li> <li>• Use of adverbs to describe verbs</li> <li>• Use of suitable nouns (naming words)</li> <li>• Pronouns used properly</li> <li>• Adjectives (describing words) used to engage reader</li> <li>• Appropriate conjunctions (joining words) used to link sentences.</li> </ul>	
Spelling e.g. <ul style="list-style-type: none"> <li>• Checked spelling of unfamiliar words</li> <li>• Used the correct homophones (same sounding words)</li> <li>• Checked endings e.g. 's' 'es' 'ed' 'ing'</li> </ul>	
Punctuation: Capital letters are used at <ul style="list-style-type: none"> <li>• Beginning of sentences</li> <li>• Titles</li> <li>• Proper nouns</li> </ul>	
Full stops are used to end sentences. Question marks are used at end of questions. Exclamation marks are used at the end of a dramatic statement.	
Writing: On re-reading, the text makes sense and can be easily understood.	

# WRITING TASK 12

## WRITING AN EXTENDED TEXT - REPORT ON COMPANY

### Write a Report on Your Company

Here are some ideas to help you with writing your report. You do not need to use them all. Your report should be two A4 pages long.

#### Introduction

Give a general overview of the company. Give its name and address and say when the company started. How many years has the company been in operation? Talk about the kind of work it carries out.

#### History / Background of the Company

Say how the company got started. Who formed it? How many staff did the company start off with – how many staff does it have now? Did the company start off with having just a few staff and develop into one that has a large workforce – has it stayed the same? Is the company still in the hands of the original owners or has it been taken over or sold on? Who used to run it and who runs it now? What kind of contracts did the company start off with? How have these contracts changed over the years? Has your company achieved any awards? If so what were they and what were they for?

#### The Company Now

What kind of work is currently being carried out by the company? Is the company involved in overseas contracts? If so say where? Is work carried out by the company in different towns in various areas of Northern Ireland/Ireland/UK etc. or does it carry out most of its work locally? Does the company advertise? If so where? Does it have a website? Describe it and give the web address? Does the company have a logo? What is it and what does it stand for?

#### Your Role Within the Company

Say how long you have worked for the company? Give the title of your job and talk about your work in a typical day. Has your work role changed over the time you have been with the company? What were your responsibilities when you started with the company and what are they now? Are you responsible for helping to train new members of staff in, for example, health and safety issues? How many people are in your team? What are the jobs of the other team members? Give details of the types of contracts / jobs you have helped to carry out (Do not give confidential client information). Have you had any interesting or unusual experiences while working for the company, for example the opportunity to travel?

#### Qualifications / Training

What kind of qualifications and training do you need for your job? What training have you had so far? What training are you undertaking at present and what are the qualifications you hope to gain when you finish your training? Talk about workplace training and college training and give the titles of the qualifications you have and the qualifications you are working towards. Give details of the health and safety training within your company. Do you have regular training sessions and fire drills? Are you required to wear protective clothing at work? If so, say when and why?

#### Conclusion

What are your views about the company? What do you enjoy about working there? Where would you like to see yourself in 5/10 years time?

# WRITING TASK 13

## WRITING AN ESSAY / ARTICLE

### Audience and Purpose

The two most important things you need to think about with any written activity are:

1. Who you are writing to (audience)
2. Why you are writing (purpose).

Audience and purpose will affect what you write and the way you write it.

### Research and Make Notes on Topic

Gather information to use in your article from e.g.:

- Course Books and Handouts
- Library
- Internet (some websites are listed at the end of this book)
- Television

Mind Map your ideas OR list points FOR and AGAINST if you are writing a balanced argument.

### Essay / Article Structure

Essays or articles have:

1. an introduction - or opening paragraph
2. a main section – or middle paragraphs - where all your points are made
3. a conclusion

With a good essay structure you catch and hold the attention of your reader as your writing will be easy to follow and understand.

# WRITING TASK 13

## **Introduction (Opening Paragraph)**

This is your first opportunity to catch the attention of your reader. If you make a good first impression the reader will want to continue reading; so make sure your introduction is interesting and engaging.

Here are some ways to make your opening paragraph interesting.

## **Rhetorical Question**

Rhetorical questions engage the reader by making them think about what is being asked e.g. “Are renewable energy technologies the solution to climate change?”

Rhetorical questions also directly address the reader giving the impression their opinion is important.

## **Quotation**

A quotation from an expert in the topic you are writing about will help persuade the reader round to that point of view,

e.g. ‘Brundtland defines sustainability as “Meeting the needs of the present without compromising the ability of future generations to meet theirs.” (Brundtland Commission 1983)

## **Dramatic Statement**

Dramatic statements immediately grab the attention of the reader.

“We need urgent action now!”

## **Balanced Argument**

A balanced argument looks at the different views on a topic and will encourage the reader to see your writing as evenhanded and unbiased e.g. “Many people argue that global warming is a result of human activity while others believe it is a result of the earth’s natural processes.”

# WRITING TASK 13

## Writing an Essay – Balanced Argument

### Is Global Warming a Result of Human Activity or is it a Natural Process?

#### Opening Paragraph - 1 - Introduction

In the opening paragraph you will need to address different views about the topic and provide more detail, perhaps giving your own point of view or the issues you intend to address.

“Many people argue that global warming is a result of human activity while others believe it is a result of the earth’s natural processes. I believe that the scientific evidence that global warming is a result of human activity is now too strong to be ignored.

#### Main Section

The middle section of a long piece of writing is made up of paragraphs. A paragraph is a series of sentences on the same topic. Each paragraph deals with a different aspect of the main essay subject.

1. Say what the paragraph is about in a **topic** sentence (a sentence that introduces the topic)
2. **Explain** the point in more detail.
3. Give an **example** to illustrate the point

#### Paragraph 2

**Topic sentence** Former Northern Ireland Environment Minister, Sammy Wilson thinks that man-made climate change is a con.

**Explanation** He believes that climate change is a result of natural processes and that the billions of pounds spent worldwide attempting to reduce carbon emissions will not solve the problem of climate change.

**Example** Mr. Wilson is convinced that the money spent on reducing carbon emissions is depriving developing countries of vital funds to tackle famine, HIV and other diseases.

#### Paragraph 3 (Opposing View)

**Topic sentence** However recent scientific studies of the Antarctic and Arctic have shown that changes to the climate are due to human activity

**Explanation** The new study of the North and South Poles by the Climate Research Unit at the University of East Anglia shows that temperature increases to Antarctica in the past 60 years cannot be attributed to natural variations.

**Example** The coastal areas of the Antarctic has been most affected by global warming which has resulted in the disintegration of ice shelves and the speeding up of the flow of glaciers to the sea.

# WRITING TASK 13

## Conclusion

Conclusions are just as important as introductions. In your conclusion you will want to sum up your arguments into an effective ending for the reader to consider.

### Conclusions should:

- Address the original question / topic
- Briefly summarise the main points of both arguments
- **Not** introduce a new idea

### In the final sentence you might want to:

- Ask a rhetorical question
- Request some sort of action
- Present a warning
- Give your own personal view
- Consider on what might happen in the future

## Conclusion

### Last Paragraph - 4

In conclusion, many believe that man-made global warming does not exist. They believe that the billions of pounds being spent worldwide in an attempt to halt global warming are diverting vital funds from developing countries where they could be used to address health and education. However, recent scientific studies indicate that global warming is, indeed, a result of human activity and that immediate action is needed to reverse the damage that has already been caused. Can we really afford not to listen?

# WRITING TASK 13

## Activity

Write a four paragraph essay giving a balanced argument on the topics below:

Writing a four paragraph essay will give you practice at writing:

- an effective introduction
- a paragraph on the first viewpoint
- a paragraph on the opposing viewpoint
- an effective conclusion

Topics:

- Is it better to self-build or buy your home?
- Are “cowboy builders” ruining the reputation of responsible construction workers?
- Are listed buildings worth all the trouble and expense?
- In these days of recession is it better to make improvements to your home rather than move?

# WRITING TASK 13



# WRITING TASK 13

## Planning a Balanced Argument

Make notes of the points for and against the topic. Then provide evidence (e.g. facts, quotes, statistics).

**Topic Statement: It is always better to self-build your home.**

**Topic Question: Is it always better to self-build your home?**

YES – I agree with the question or statement	NO – I do not agree with the question or statement
Point 1  Explanation   Example	Point 1  Explanation   Example
Point 2  Explanation   Example	Point 2  Explanation   Example
Point 3  Explanation   Example	Point 3  Explanation   Example
Point 4    Explanation   Example	Point 4    Explanation   Example

# WRITING TASK 13

## Linking Words and Phrases

When writing an article we use different **words and phrases** to link together our ideas. We use them to help build an argument, compare and contrast ideas and to sum up what we have said.

### USE FOR BUILDING AN ARGUMENT

Firstly	Also	Therefore	No one can deny
In addition	As well as this	Moreover	Some would argue
It might be said	Consequently	As a result	Convincingly
What is more	For that reason	Besides	Importantly

### USE WHEN COMPARING / CONTRASTING IDEAS

In comparison	As well as	Just as	Also
Similarly	At the same time	equally	Similarly
Just as	Likewise	In the same way	Both
Despite	Those who disagree may argue	But	Although
However	In contrast	On the other hand	Though
Although	Nevertheless	Conversely	Opponents of this view would claim
On the contrary	Still	On the other hand	In opposition to this

### SUMMING UP IDEAS

In conclusion	To conclude	In summary	To sum up
To Summarize	Finally	To outline the main points	Overall
To recap	On balance I believe	Lastly	To finish

# WRITING TASK 13

## FORMAL LETTER – LETTER OF COMPLAINT

### Letter of Complaint

Effective complaints are more likely to produce better outcomes. Letters are the most reliable way to complain although complaints may be made using emails or phone calls.

The most effective complaints are:

- **Brief** – short, sharp letters can be quickly read and understood.
- **Professional** – Well written and professionally presented letters will command respect and will be taken more seriously.
- **Factual** – they give the reader all the facts they need to process the complaint (names, dates, times, what you want to happen etc).
- **Constructive** – Even if you are angry they should contain positive statements and suggestions. A positive approach is more likely to have a positive outcome.
- **Cooperative** – No matter how aggrieved you feel it is important to remember that aggression will not encourage a positive response. A positive letter will encourage the reader to respond positively.

# WRITING TASK 14

## Letter of Complaint

### Example

<p><b>Name</b>  <b>Position</b>  <b>Company</b>  <b>Address</b>  <b>Post Code</b>  <b>(of the person you are writing to)</b></p>	<p><b>Your Address</b>  <b>Post Code</b>  <b>Telephone Number</b></p>
<p>Dear (name of person) or          Dear Sir / Madam (if you do not know the person's name)</p> <p><b>Heading</b> alerting the reader immediately to the main issues of the letter, briefly outlining the problem and relevant details (name, product, reference number etc).</p> <p><b>Introduction</b> State the facts simply</p> <p><b>Main Section of Letter</b>          Give relevant details.          Let the reader know what you would like to happen (make a positive request for help in sorting out the problem) to which the reader can respond.</p> <p>It is best to end by including positive comments about the company (e.g. previous service etc).</p> <p>Even if you are very angry it is best to end on a complimentary note.</p> <p>Even if the complaint is long and complicated the letter should still be short and to the point. Further explanations, notes etc should be attached.</p> <p>I look forward to hearing from you.</p> <p><b>Yours sincerely</b> (if you know the persons' name) - <b>Yours faithfully</b> (if not).</p> <p><b>Your Signature</b> (in black or blue ink only)</p> <p><b>Your name printed clearly</b></p>	<p><b>Date</b></p>

# WRITING TASK 14

## Writing Task

### Responding to a Letter of Complaint

You receive the following letter complaining about some work you have just carried out. You know the work you carried out was on time, to the proper standard and was correctly priced (the customer signed that she was satisfied with the work completed). Write a letter responding to this complaint.

Remember:

Always be concise, professional, factual, constructive and cooperative.

# WRITING TASK 14

## Letter of Complaint

### Example

16 Cottage Row  
Ballyrowan  
Co Down  
BT30 7MC  
Tel: 07709 432 234

Mr Frank Ritchie  
Customer Services Manager  
Self Build Supplies  
Belfast Industrial Estate  
Boucher Road  
Belfast  
BT12 4HC

10th September 2010

Dear Mr Ritchie

**Re: Pipes and Water Tank Insulation Order – Order No PWTL4567**

The above order (due delivery date 15th August 2010) has still not arrived even though I was expecting it around the middle of August.

Will you please check for me what has happened to the order and let me know when I can expect it to arrive?

It is very important that I receive the order within the next week as North West build is due to be insulated the week beginning 17th September.

I have ordered insulation materials from you for 10 years and know you are an excellent supplier, so I know you will do everything you can to sort this matter out for me.

I look forward to hearing from you.

Yours sincerely

Jack Roberts

# WRITING TASK 14

## Letter of Complaint

Holiday Hotel  
Dunrowan  
Co Down  
BT26 7RC  
Tel: 07709 642 543

Mr Tom Frazer  
Joinery and Building Services  
Belfast Industrial Estate  
Belfast  
BT10 7HC

20th September 2010

Dear Mr Frazer

### **Re: Loft Conversion**

I have just received your invoice for the loft conversion you carried out recently at my hotel. I have to say I am stunned. The amount we agreed was much less than the amount you are now billing me for.

Also I am not at all happy with the work you carried out. The work was completed two weeks after you said it would be completed and it was not up to the standards I expected. You were recommended to me by friend and I expected much better from you.

I certainly won't be recommending you to anyone – unless of course I receive a massive discount on the work you have carried out.

I look forward to hearing from you.

Yours sincerely

Sylvia Smith  
Manager of the Holiday Hotel

# WRITING TASK 14

## Writing Task

### Writing a Letter of Complaint

You are a self employed joiner and have recently refitted a home with outside doors and double glazing. The invoice you sent was ignored as was the reminder you also sent. Write a letter of complaint to your customer outlining the issues and reminding him of your policy to pursue outstanding debts through the courts.

Remember that the same rules apply to this letter of complaint as to the others: always be professional, concise, factual, constructive and co-operative.



# WRITING TASK 14

## Complaints Letter – Proofreading Check List

NO		SCORE 1-10
1.	I considered my audience (the person who will receive my complaint).	
2.	I considered the purpose (my reason for writing)	
3.	Letter was written in formal letter format with proper spelling, punctuation and grammar.	
4.	It was clear and concise. Any extra information was attached rather than included in the letter.	
5.	It contained all the relevant facts and information needed to resolve my complaint.	
6.	It included positive statements and suggestions.	
7.	The tone of my letter was thoughtful and cooperative.	

# WRITING ANSWERS TASK 1

## SENTENCES

### Answers to Activities 1 and 2

1. Internal finishes must be carried out in the proper sequence.  
**Complete**
2. It is essential that care is taken to avoid damage once a finish is applied.  
**Complete**
3. The standard of workmanship must be to the highest level.  
**Incomplete**
4. When applying a finish it is important that the background is perfectly dry.  
**Incomplete**
5. When considering which finish to use, it is important to think about how the building is going to be used and the wear, tear and maintenance of the building.  
**Complete**
6. There are two types of finish; self finish and applied finish.  
**Incomplete**
7. Types of wet finishes are plaster, paint and wallpaper.  
**Complete**
8. A problem with wet finishes is the amount of time it takes to dry out.  
**Incomplete**
9. Wet finishes may cause expansion or shrinkage of the timber components of the build.  
**Incomplete**
10. Plaster board, timber panelling and carpet are all examples of dry finishes.  
**Incomplete**
11. Dry finishes cause no shrinkage and do not prevent occupancy of the building.  
**Complete**
12. Self finish is inherent in the material and does not need to be applied on.  
**Complete**
13. Natural stone, facing brick, natural slate and natural wood are all types of self finishes.  
**Complete**
14. There are two basic methods of carrying out internal plastering.  
**Incomplete**

# WRITING ANSWERS TASK 1

15. The most popular method of applying internal plastering is to apply one or two coats of sand and cement on block or brick walls followed by a coat of gypsum plaster.

**Complete**

16. Another method of applying internal plastering is to use a lightweight gypsum undercoat followed by a finish coat of gypsum plaster.

**Complete**

17. Sand and cement takes longer and is harder to apply than lightweight gypsum undercoat.

**Complete**

18. Sand and cement mixture is much more hard wearing.

**Incomplete**

19. Lightweight gypsum undercoat is used where good thermal insulation properties are needed.

**Complete**

20. Painting is used in buildings to preserve it, to improve its appearance and for reasons of hygiene.

**Incomplete**

21. When completing a painting job a primer is used first, followed by an undercoat and ending with a finish coat.

**Complete**

22. The correct primer must be used depending on the material to be covered.

**Complete**

23. Primer sticks to surface of the material and evens out the surface.

**Incomplete**

24. Primer is useful for controlling rust.

**Incomplete**

25. Primer provides a good surface for the undercoat to adhere to.

**Complete**

26. Undercoat helps to even out an irregular surface.

**Complete**

27. The colour of the undercoat should be an appropriate shade to match the colour of the finishing coat.

**Incomplete**

28. Normally two coats of undercoat are needed to reach the proper standard.

**Incomplete**

29. The finishing coat adheres to the undercoat and gives a protective layer, the desired colour and outer texture.

**Incomplete**

# WRITING ANSWERS TASK 2

## Answers – Simple – Compound – Complex Activity

Which of the following are simple, compound or complex sentences.

1. Scaffolding is a temporary structure.

**Simple sentence**

2. Scaffolding is erected by a trained scaffolder and only a trained scaffolder can dismantle scaffolding.

**Compound sentence**

3. Unless a construction worker is properly trained, he/she cannot use a scaffold.

**Complex sentence**

4. Before using a scaffold, you must read the official publications that contain the regulations for safe use of scaffolding.

**Complex sentence**

# WRITING ANSWERS TASK 3

## PUNCTUATION

### Answers Activity 1

1. The method of producing bricks has changed since they were first used in building.
2. How do I reduce my carbon footprint?
3. Do bricks have many advantages over other types of building materials?
4. NEVER use power tools near flammable substances!
5. What are the main benefits of home insulation?
6. The majority of staircases used in domestic construction are made from solid timber.

### Answers Activity 2

1. Seeking to improve the quality of our environment, the Department for the Environment provides Area Plans for our towns and villages.
2. The Planning Department prepares an Area Plan for all towns which consists of diagrams, illustrations, maps and written information.
3. Unless new development plans fit in with the Area Plan, they may not be passed.
4. If it has a good reason, the department can alter a development plan.
5. The department can alter a development plan, at any time, if a good reason is given.
6. Northern Ireland's planning policy, "Sustainable Development in the Countryside," will apply a policy similar to Greenbelt policy to the whole of Northern Ireland.
7. The only types of buildings that are encouraged in the countryside are replacement dwellings, farm workers dwellings and retirement dwellings for farmers.
8. Any new dwellings built must integrate into the countryside, be of an approved design and reflect the area in which it is situated.
9. Building design in conservation areas, including size of buildings, brickwork, doors and windows, will be restricted.
10. Area Plans will provide protection for interesting buildings such as those of architectural interest, historic interest and areas of special character and appearance.

# WRITING ANSWERS TASK 3

11. To preserve and enhance special places, they are protected as Conservation Areas.
12. The Moravian village of Gracehill, outside Ballymena, is one of the best preserved villages of its kind in Western Europe.

## Answers Activity 3

1. The vacancy advert in the paper suits me: it's looking for someone with experience in fitting kitchens.
2. Construction site safety signs are vital: they are a constant reminder of the hazards in the workplace.
3. Instruction leaflets are useful: they save time and money when planning a DIY job.
4. Peter made a list of the tools he needed to erect the fence: protective gloves, long tape measure, spade, 2 builders' lines, panel saw, power drill with twist and wood bits, club hammer, spirit level, trowel, hammer, canes.

## Answers Activity 4

1. Ladders are not always the best equipment for the job; a mobile tower, Air Port Steps or scaffolding may suit better.
2. There can be no short cuts on safe practice; inspect your ladder regularly.
3. Some jobs will require the use of an extension ladder; always make sure you extend it before climbing.
4. You will need to secure the bottom and the top of the ladder; you do this by tying it to the stiles (not the rungs)

## Answers Activity 5

### Dashes

1. Sprains and strains – to muscles joints, ligaments, tendons, disc trouble and hernias – are often caused by sudden awkward movements while lifting.
2. When I first started work with Renovations Workshops – at the beginning of my apprenticeship – I was given an induction talk and had training in Health and Safety.
3. When taking nails from old rafters – or beams if this is required – I use a metal detector to find nails that cannot be seen.
4. The company specialises in selling sash windows and their boxes – mainly trading in the Waterford area – but also carries out other renovation work on period houses.

# WRITING ANSWERS TASK 3

## Brackets

1. Sprains and strains (to muscles joints, ligaments, tendons, disc trouble and hernias) are often caused by sudden awkward movements while lifting.
2. When I first started work with Renovations Workshops (at the beginning of my apprenticeship) I was given an induction talk and had training in Health and Safety.
3. When taking nails from old rafters (or beams if this is required) I use a metal detector to find nails that cannot be seen.
4. The company is specialises in selling sash windows and their boxes (mainly trading in the Waterford area) but also carries out other renovation work on period houses.

## Answers Activity 6

### Speech marks

1. The driver asked Jack, "Where do I leave the supplies?"
2. "Have you completed your training on Health and Safety legislation,"the tutor asked the group?
3. "Did Joe pass on the memo to you," the receptionist asked?
4. Frank said, "We finish tomorrow for our holidays."

### Inverted Commas

1. Environmental correspondent, Richard Black (BBC News website) in his article "Big profit from nature protection" says that "money ploughed into protecting wetlands, coral reefs and forests can bring a hundredfold return on capital."
2. Tom thought his manager was a bit of a "jobs worth" until he realised that the rules were legal requirements that kept him and his colleagues safe.
3. The title of Peter's assignment was "Health and Safety Policies improve safety on site"

# WRITING ANSWERS TASK 4

## **Answers – Apostrophes - Activity 1**

1. 'Belfast Building Supplies for cheaper bricks!'
2. Stepladders are one of the most important pieces of equipment in the construction industry.
3. In some types of construction rooms are know as cells.
4. Bricks are produced to withstand heavy loads.
5. The ceiling joists are only 100mm deep.
6. Stairs should be safe.
7. Employers must make sure equipment is safe.
8. Windows are available in different shapes, sizes and materials.

## **Answers – Activity 2**

The joiner's last job took them four days to complete.

The ladder's rung was broken.

The builder's square is useful for cutting plywood.

## **Activity 3**

1. They're throwing a party when the new build is complete.
2. You're the best candidate for the job.
3. It's important to use the proper tools for the job.
- 4 Individual answers



# WRITING ANSWERS TASK 4

## Email

**To...** hcurran@abc.com  
**CC...**  
**Subject: Saturday Job!**

Hi Hadyn

I **haven't** had a minute since I last saw you. **How's** the new job going? Hope **you're** not working too hard! **I'm** making a start on the conservatory next Saturday and I was wondering if **you'd** be interested in some weekend work.

**Everything's** worked out well and all the materials have been delivered already so **we're** ready to rock! **I've** just spoken to Barry and he's said he can give us a hand with the electrics.

You **wouldn't**, by any chance, have Adam's mobile number? **I'm** hoping **he'll** tip in as well because **it's** hard to beat a good team!

Let me know anyway and **I'll** see you soon.

Rory

# WRITING ANSWERS TASK 4

Email text with contractions written out in full.

To... hcurran@abc.com  
CC...  
Subject: Saturday Job!

Hi Hadyn

I **have not** had a minute since I last saw you. **How is** the new job going? Hope you are not working too hard! **I am** making a start on the conservatory next Saturday and I was wondering if you would be interested in some weekend work.

**Everything has** worked out well and all the materials have been delivered already so we're ready to rock! **I've** just spoken to Barry and **he's** said **he'd** give us a hand with the electrics.

You **wouldn't**, by any chance, have Adam's mobile number? **I'm** hoping **he'll** tip in as well because **it's** hard to beat a good team!

Let me know anyway and **I'll** see you soon.

Rory

# WRITING ANSWERS TASK 5

## VERB-SUBJECT AGREEMENT

1. The Health and Safety at Work (Northern Ireland) Order **requires** that employers must provide a safe place of work.
2. Employers must provide equipment that **is** suitable for the job.
3. Four main types of ladders **are** used in the construction industry.
4. Standing ladders **have** rectangular or round stiles.
5. The wooden ladders **was** made from Douglas fir.
6. The aluminium ladder **was** easier to carry.
7. Bob **does** not like using extension ladders.
8. The wooden ladder **needs** to be reinforced with wire.
9. Paul checked that no-one **was** using the ladder before taking it.
10. Ladders **have** to be placed on flat surfaces.

# WRITING ANSWERS TASK 6

Presumably they would both still be employees so the present tense is used here.

## Verb tenses Answer

John Briars and his supervisor Phillip Reid, **are** employees of Adams Building Contractors, a Northern Ireland building and construction company.

They **were** replacing house windows at number 42, Beach View Estate in Holywood, and had just **started** back to work after lunch at 2pm.

John **rested** a ladder on some grass. The ground **looked** fairly stable even though it **was** sloping slightly away from the building. He did not tie the ladder or secure it by any other means.

Phillip had gone inside the building to collect some tools and so **was** not there to foot the ladder.

John began carrying some silicon sealant up the ladder for the new window. When he had **reached** a height of about 3m the bottom of the ladder **slipped** out and he fell. John **fractured** his leg badly.

The verbs relating to the event are all in past tense

# WRITING ANSWERS TASK 7

## HOMOPHONES

### 1. Are, Our and Hour

- a. Windows are available in a variety of designs, shapes, sizes and materials.
- b. Our course tutor is a stickler on Health and Safety issues.
- c. We practice bench joinery construction in our workshop at college.
- d. Vertical sliding sash windows are often used in Georgian Architecture.
- e. Windows are often part of the external cladding of an office building.
- f. Often there are several different types of roof in one building.
- g. The majority of staircases used in domestic construction are made from solid timber.
- h. Our group had a three hour risk assessment training on Tuesday.
- i. Always ensure that roof coverings are in harmony with the local environment and that they are fit for purpose.
- j. Our new workshop is well equipped.

### 2. They're / their / there

- a. They're planning to start the new build in May.
- b. A private staircase serves one dwelling. They are normally manufactured in a workshop to specific dimensions.
- c. Most modern windows are casement windows. Their hinges are placed on the side to allow them to swing open vertically, like a door.
- d. Their site plans gave the position of the proposed dwelling.
- e. Bench joiners use their portable power tools more often than their hand tools, but they're both important.
- f. Chisels work best when they're very sharp.
- g. When using hand tools there can be danger of injury from fast-flying objects.

### 3. Where / were / wear / we're

- a. On the construction site, it is important to wear safety hats and footwear to protect from falling objects.
- b. It is important to wear high visibility vests to let others see exactly where you are.
- c. We're all agreed that where Health and Safety is concerned, it's better to be safe than sorry.
- d. Robert knew how important it was to know exactly where all his equipment was.
- e. If you are using hand tools it is vital to wear the correct Personal Protective Equipment (PPE) for the task.
- f. It is important to know when and where to use particular hand tools.
- g. We need to maintain tools to protect them from wear and tear.
- h. Never wear loose clothing or jewelry when working with hand tools as they could catch on the tools.

# WRITING ANSWERS TASK 7

## 4. Who's or Whose?

- a. Make sure you know whose job it is to carry out a risk assessment on the electrical wiring job.
- b. "Who's the new supervisor at the Timber Stores?"
- c. Whose hammer is this?"
- d. 'Whose name is on this kit?'

## 5. To / Two / Too

- a. The joiners knew that if they accepted another job they would have too much work on to be able to complete on time.
- b. Most garages are too small for modern cars.
- c. Disruption to your home life can be kept to a minimum for most garage or loft conversions.
- d. The job would take two hours at the most.

# WRITING ANSWERS TASK 8

## PARAGRAPHING

### Activity 1

- 1**
  - a Health and Safety at Work
  - b There was a great canteen there as well.
  - c The paragraph is about health and safety at work but the sentence is about the workplace canteen.
  
- 2**
  - a Energy Conservation Within Walls
  - b Northern Ireland MP Sammy Wilson believes that man-made global warming is a con.
  - c The paragraph is about the government's building regulations on conserving energy through wall insulation and S Wilson's comments are not relevant.
  
- 3**
  - a Timber Framed Buildings
  - b I was always good with jigsaw puzzles and mechano sets when I was a child.
  - c The topic is timber framed windows and this sentence is about childhood experience with toys.
  
- 4**
  - a Adding Space to Your Home
  - b My neighbour says he would rather move house rather than have all the hassle of renovation.
  - c The paragraph is about ideas on how to renovate a home to make more space. This sentence gives a personal opinion that has nothing to do with renovating a dwelling.
  
- 5**
  - a Redeveloping the Titanic Quarter
  - b Leonardo de Caprio and Kate Winslett starred in the classic film Titanic in 1997.
  - c The sentence is about a film while the rest of the paragraph is about the redevelopment of the Titanic Quarter.

# WRITING ANSWERS TASK 8

## Activity 3

1. Local stone was once the traditional choice when constructing dwellings and industrial buildings. Stone walls were generally very thick and had no damp proofing. Smaller stones were inter spaced with the larger ones and were bound together with lime mortar. More recently stone walls have been built with sand and cement.
2. The red brick terrace houses built in close proximity to mills during the industrial revolution were built one-brick thick. They were cheaply constructed using bricks that were made locally and English Bond to form a solid wall. A problem with one-brick wall construction was that moisture travelled from the outside causing damp patches on the inside of the building.
3. Cavity wall construction was developed to prevent the spread of damp into the inside of the buildings. Cavity walls are two walls with a space between. Moisture could not travel from the outside of the building to the inside. It also helps to keep in heat. Energy loss needs to be reduced further so existing cavity wall insulation will need to be improved even more if a reduction in heat loss is to be achieved.
4. Timber framed walls differ from those constructed of traditional brick and block work because the structure is composed of wood. Timber framed structures must comply with every aspect of the building regulations including fire resistance.
5. Curtain wall construction is used for commercial and industrial structures. Curtain wall structures have infill panels of glass or opaque materials. They often have an inner wall consisting of block.





# Speaking and Listening **Tasks and Answers**



## **SPEAKING AND LISTENING**

Speaking and listening important parts of your everyday communication within the construction industry.

Every day you will speak to your supervisor, site visitors, colleagues, clients, college tutors and other students.

You will provide others with important information and respond to information given to you by others.

To obtain your Level 2 qualification in Communication you will need to take part in a group discussion and a short talk.

# SPEAKING AND LISTENING TASK 1

## SELECTING MAIN POINTS FOR A PURPOSE

**Read the text below and complete the activity at the end.**

You've arranged to pick up your colleague, Tom, in the works van at 7.30am and then drive to Building Supplies LTD to collect your order to plumb three domestic residences.

Unknown to you, your dog has taken a liking to your new, cool and expensive, key ring and has taken it into the garden to bury. The spare keys of the van are at work.

After twenty minutes searching all the usual places, your ten year old brother thinks he remembers seeing the dog with something resembling your key ring in his mouth and tells you he saw Amigo digging in the garden a while ago.

You both dash for the kitchen door at the same time. He is still carrying his bowl of Weetabix which he spills and you slip on. You think you might have broken your ankle. Your brother doesn't notice and runs on into the garden to dig up your key ring from the mound of earth Amigo has buried it under.

Your ankle turns out to be just badly bruised but it is not broken. The problem now is that you will be half an hour late to pick up Tom.

You ring Tom to let him know the new arrangements. Your call goes through to voicemail. What message will you leave him?

### Activity

**Write your message in the box below. Remember your AUDIENCE and PURPOSE and make the message as clear and concise as possible.**

# SPEAKING AND LISTENING TASK 2

## DISCUSSION - PAIRS - CAREER PATH

Divide into twos

Read through the questions below then think about and make notes on your ambitions for the future. Just keywords will do.

**What do you want to be? Why?**

**What do you need to do to achieve your ambitions? What qualifications / training do you need? How long will it take?**

**Will you need to do work experience?**

# SPEAKING AND LISTENING TASK 2

**What personal qualities / employability skills will you need to succeed?**

**What would be your second choice of career? Why?**

Now tell your partner about the career path you intend to follow and recount your partner's story to the group.

# SPEAKING AND LISTENING TASK 3

## GROUP DISCUSSION

### Sample Notes for Discussion

#### Topic: How important is good communication in the workplace?

##### Types of Communication

- Interaction with customers, supervisors, site visitors, other departments and other members of team
- Contract documents, plans etc
- Instructions – written or verbal
- Telephone
- Emails – internal and external
- Memos – within organisation
- Formal letters – outside organisation
- Meetings
- Individual briefings
- Presentations
- Reports
- Forms

##### Good Communication (examples)

- Effective interaction with customers and other staff
- Co-operating effectively with customers and other
- Giving and receiving information effectively
- Pleasant and helpful telephone manner
- Accurate records kept up to date
- Information passed on promptly to relevant people
- Good non-verbal communication (body language, eye contact)

##### Results of good communication

- Staff will work well as a team
- Work will be completed correctly and on time.
- Customers will recommend business to others
- More contracts

##### Consequences of poor communication

- Without effective workplace communication the machinery of an organisation would break down
- Work would not be completed on time or to the correct standards
- Staff will feel dissatisfied and leave
- Business may fail

##### Conclusion

Good communication and the sharing of information are essential for the success of a company. Without it a company would become disorganized, customers would become dissatisfied and workers would become demoralized and the company would fail.

# SPEAKING AND LISTENING TASK 3

## Activity

Choose a topic and question to discuss. Arrange a time to have your discussion. The discussion will take 15-20 minutes.

Research the topic and make out a set of notes. You will want to include relevant issues you would like to explore and questions you would like to ask.

## Some Topic Suggestions:

1. Are changes to the environment always beneficial?
2. How important is thorough research and planning when planning a construction job?
3. Are renewable energy technologies the way forward in creating cleaner and more affordable energy.

## You will be assessed on:

- Speaking clearly
- Keeping to the point
- Giving relevant information
- Listening and responding to others
- Using positive body language
- Keeping the discussion going.

**Topic: Are Renewable Energy Technologies the Way Forward in creating cleaner and more affordable energy?**

## Issues:

1.

2.

3.

# SPEAKING AND LISTENING TASK 3

**How issues are being addressed at the moment:**

1.

2.

3.

**What I think should happen to improve situation e.g. development of projects:**

1.

2.

3.



# SPEAKING AND LISTENING TASK 3

**Questions I would like to ask the group:**

1.

2.

3.

**Conclusion:**

# SPEAKING AND LISTENING TASK 4

## RATE YOUR PERFORMANCE - GROUP DISCUSSION CHECKLIST

<b>Name:</b>
<b>Topic:</b>
<b>Date:</b>

NO	SKILL	GRADE 1-10
1.	I researched and made notes on the topic for discussion	
2.	I listened carefully to others to identify relevant information	
3.	I followed and paid careful attention to longer explanations, instructions etc.	
4.	I answered detailed / extended questions	
5.	I dealt appropriately with criticism noting the points they made and accepting that others will not always agree with my point of view.	
6.	I offered constructive criticism i.e. I suggested ways that others might make improvements.	
7.	I spoke clearly and confidently to suit the situation	
8.	I asked questions to obtain detailed information.	
9.	I expressed facts clearly.	
10.	I made sure the information I provided was in the proper order. develop & clarify/confirm information	
11.	I developed, clarified, or confirmed information provided by others	
12.	I made relevant contributions & help move discussion forward	
13.	I adapted my contributions to suit the audience, context, purpose, situation	
14.	I used appropriate phrases for interruption or to change the topic.	
15.	I supported my arguments and opinions with evidence.	
16.	I made sure that my attitude was reassuring to others e.g. I used appropriate body language, phrases etc.	

# SPEAKING AND LISTENING TASK 5

## ONE MINUTE TALKS

To practice for your 4 minute short talk, choose a topic from the list below – or one you have chosen yourself - and speak for one minute on it.

### Remember:

- Plan your talk
- Remember your audience and purpose
- Will you use formal language, informal language a mixture of both?
- Have an introduction - a main section where you develop your ideas – and a conclusion.
- Support opinions and arguments with evidence e.g. facts / quotes
- Clarify information e.g. technical terms
- Speak with enthusiasm.
- Stick to the topic
- Vary tone of voice to keep the listeners' interest
- Use good body language – open and relaxed
- Maintain good eye contact

### Topics:

- Risk Assessment
- Renewable Energies
- Improve or Move
- An Aspect of Your Job
- Building an extension
- Choosing wood from sustainable sources

# SPEAKING AND LISTENING TASK 6

## RATE PRESENTATION PERFORMANCE - CHECKLIST

<b>Name:</b>
<b>Topic:</b>
<b>Date:</b>

NO	SKILL	GRADE 1-10
1.	I used notes or PowerPoint slides to help structure talk and to introduce each new section	
2.	I used appropriate formal and/or informal language according to audience and purpose	
3.	I spoke clearly and was easily understood.	
4.	My voice was at the right pitch and everyone heard me.	
5.	I varied the tone so that my audience did not get bored.	
6.	I remembered all the points I wanted to make.	
7.	I made the points in the proper order.	
8.	I supported the arguments and opinions I made with evidence (e.g. facts, quotes, statistics).	
9.	I clarified difficult words or technical terms or phrases	
10.	I spoke at the right speed – not too quickly.	
11.	My body language was relaxed	
12.	I maintained good eye contact with my audience.	
13.	I did not read from a script.	
14.	Talk was completed within the timescale.	
15.	I invited questions from the audience.	

# SPEAKING AND LISTENING TASK 7

## TOOL BOX TALKS - HEALTH & SAFETY

Tool Box Talks are short refresher talks on health, safety and environmental aspects of the jobs you do on a day to day basis. Tool Box Talks are important because they keep you alert to the hazards that occur in the workplace.

Preparation of toolbox talks will also help you prepare for your 4 minute short talk.

Choose your topic from the list below. Information on the topics can be found at:

**[www.healthandsafetytips.co.uk/Toolbox\\_Talk](http://www.healthandsafetytips.co.uk/Toolbox_Talk)**

TOOL BOX TALKS	TICK	TOOL BOX TALKS	TICK
Site tidiness and security		Scaffolding/ladders and working at height	
Personal Protective Equipment		Health Hazards	
Energy Conservation		Manual handling	
Excavation Safety		Plant and Machinery	
Environmental Awareness		Spill Control	
Power and Hand Tools		Walkway routes	
Storage and use of fuel and oils		Safety signs	
Accident reporting		Working on roofs	
Working in Confined Spaces		Slips, Trips and Falls	
Fire prevention		Working Near Services	

# SPEAKING AND LISTENING TASK 8

## PRESENTATION - APPRENTICES IN THE DRAGON'S DEN

### Small Group Activity

Divide into small groups and then read and discuss the scenario below.

**The firm you work for is an apprentice's dream. It is offering its apprentices – including you – the opportunity to build a complex of their choice. Any profit that you make from the success of your project will be yours to keep. You might never need to work again!**

All you need to do is convince your employers that your project will be successful. You will need to prepare to enter THE DRAGONS' DEN. With others in your group you must prepare a presentational pitch that will convince your employers to give you this life-changing opportunity.

### Think about:

- What you will build
- Where you will build it
- Design considerations you will need to take account of
- How you plan to make a profit from your project

Everyone in the group must make a contribution. One member of the group should be appointed to take notes and you may use power point and/or whichever props you think are appropriate (e.g. photos, models etc).

Prepare your pitch and make your presentation to the Dragons.

**REMEMBER:** The dragons will spot any weaknesses in your pitch. For this to work you must present a united front and be prepared to answer questions.

# SPEAKING AND LISTENING TASK 8

Using the pro forma page provided take note of the disagreements that arose as you prepared your presentation. Say how you went about avoiding conflict and reaching agreement. When disagreements arose, how did you resolve them, avoid conflict and come to an agreement?

## Coming to an Agreement

NO	DISAGREED ON ...	CAME TO AGREEMENT BY ...
1		
2		
3		
4		
5		

# SPEAKING AND LISTENING TASK 8

Now produce a PowerPoint to prepare for your pitch to the Dragons. PowerPoint slides will be very useful for structuring your talk and introducing each new section.

Your Pitch Will Be Assessed On:

- Speaking clearly and confidently to suit the purpose and situation
- Use of logical sequencing
- Expressing clearly statements of fact using appropriate format, language etc
- Supporting your opinions and arguments with evidence.
- Adapting contributions to suit audience, context, purpose and situation.
- Use of appropriate body language, phraseology, tone etc.

The 'Dragons' may be your teacher/s or a combination of teacher/s and students.



# SPEAKING AND LISTENING ANSWERS

## TASK 1

**“Sorry Tom, I’m going to be late. Slight accident – nothing serious. Pick you up at eight.”**



# ACTION-BASED ACTIVITY GUIDANCE



# ACTION BASED ACTIVITY GUIDANCE

## IDEAS FOR ACTION-BASED ACTIVITIES.

### Built Environment

#### Action-based activities for literacy level 2

1. What are the developers' aims for Belfast's Titanic Quarter? Are they realistic?
2. Investigate ONE occupation within the Built Environment e.g. construction/ plumbing & heating / wood occupations / trowel occupations / interior design / electrical engineering / painting and decorating / landscape gardening. Is this a job you would like?
3. How important is thorough research and preparation when planning a job within the built environment?
4. Are renewable energy sources the answer to energy conservation?
5. Look at how the natural environment (air, forests, water etc) can sometimes be detrimentally affected by the built environment. Can anything be done to prevent this?
6. Is global warming a result of human activity or is it a natural process?
7. Research health and safety requirements within a built environment occupation e.g. construction / plumbing / wood occupations / trowel occupations etc. Write a report on the importance of the health and safety requirements.
8. Investigate the history of one or more, old building.
9. Research a prestige building, such as the Millennium Dome and explore how successful the project was.
10. Investigate how a built environment occupation has changed within the last 100 years.
11. How important is risk assessment when planning a construction job?
12. What design considerations need to be taken into consideration when planning a construction job?
13. Are listed buildings worth the all the trouble and expense? (How should we go about protecting our 'Heritage at Risk' in Northern Ireland?)
14. In these days of recession is it better to move home or to make improvements?
15. How can we be sure the wood we buy is from sustainable forests?

# ACTION BASED ACTIVITY GUIDANCE

16. Is wood the building material of choice for the 21st century? Discuss the benefits and drawbacks of timber frame and brick build housing.
17. Do Eco builds make financial as well as environmental sense?
18. Is it better to self-build or buy your home?
19. How would you go about adding value to a property?
20. Are “cowboy builders” ruining the status of reputable building companies? What can be done to prevent this?

# ACTION BASED ACTIVITY GUIDANCE

## RESEARCHING INFORMATION USING ICT

### Researching Information Using ICT

- Be clear about the topic you are exploring.
- Know the purpose of your research. For example, are you gathering information to write an article or a report for your portfolio? What is your topic?
- List the web addresses that are useful to you. Say why they were of use. Use the proforma page provided which can be added to your portfolio as evidence of your research.
- List the web addresses that you explored but were of no use to you. Say why this was the case. Again enter these on to the page provided. Include title, author of document and date of publication.
- Find two 500 word documents for L2 on your chosen topic.
- Read and extract the main points from the documents for the purpose you have intended, for example, 'Notes for a Newspaper Article on CO2 Emissions' or 'Notes for a group discussion on Effectiveness of Renewable Energies.'

# ACTION BASED ACTIVITY GUIDANCE

Topic:

Useful Websites:

WEB ADDRESS	WAS USEFUL BECAUSE

# ACTION BASED ACTIVITY GUIDANCE

Topic:

Unhelpful Websites:

WEB ADDRESS	WAS USEFUL BECAUSE

# ACTION BASED ACTIVITY GUIDANCE

## ESSENTIAL SKILLS ACTION-BASED ACTIVITY L2 GUIDANCE

ACTIVITY	EVIDENCE	DATE ACHIEVED
1. Using a Mind Map select a topic for exploration and formulate a question to be addressed (Map the topic to the themes and topics set by CEA/City & Guilds)	Mind Map	
2. Find two documents that will help answer the questions set. Each document must be 500 words long ** Setting a summary as a task is inappropriate	Chosen documents on <b>same</b> subject	
3. Read the documents and highlight the key or main points <b>Make notes</b> (see 'Notes' template)	Highlighted documents <b>Two</b> sets of notes based on chosen documents	
4. Write two different types of documents each one must contain information that is relevant to the topic.  Documents can include business letter (see standardized template) short report, essay, illustrated leaflet or advertising information. <b>One of the documents should answer the question set in the Mind Map.</b>  <b>This piece of work will be regarded as a summary of the two documents.</b>  <b>Learners are required to use at least one image in the development of their portfolio. (Not a table of text/numbers)</b> If using an image in report/essay the image should be integrated into this piece of writing and referred to in the written text.	Formal/business letter Essay/Report Use of image	
5. Engage in a group discussion (An image may be used here to illustrate a relevant point)	Preparation notes Tutor feedback sheet	
Give a 4 minute talk (An image or images may be used here to illustrate relevant points).	Preparation notes PowerPoint / handouts / leaflets Tutor feedback sheet	

The portfolio should be:

- On a topic linked to your vocational course or based on something that interests you.
- It should be unique and individual.
- Tutors must annotate each piece of written work. For example – Criteria C1.3 met
- If you use more than one research document then you must produce a set of notes for every document



# ACTION BASED ACTIVITY GUIDANCE

## MAKING NOTES

<b>Title of Article:</b>
<b>Source:</b>
<b>Author:</b>
<b>Number of Words:</b>
<b>Date Published:</b>

**Purpose and intended audience of document:**

--

**Main Points**

1.
2.
3.
4.
5.
6.
7.
8.



## **SAMPLE PORTFOLIO ACTION-BASED ACTIVITIES LEVEL 2**



# SAMPLE ACTION BASED ACTIVITY

## ESSENTIAL SKILLS – COMMUNICATION LEVEL 2

<b>Candidate Name:</b>	<i>A. Student</i>
<b>Registration Number:</b>	<i>REG2345678</i>
<b>Registration Date:</b>	<i>24.03.10</i>
<b>Assessor Name:</b>	<i>A Tutor</i>

LOCATION OF EVIDENCE			PAGE NUMBER
C2.1a	Discussion	Observation Sheet	
C2.1b	Talk	Observation Sheet Supporting Evidence	
C2.2	Reading	Source Document 1 Source Document 2 Summary	
C2.3	Writing	Document 1 Document 2	
	Image		

<b>Candidate signature</b>	<i>A. Student</i>	<b>Date</b>	<i>17.05.10</i>
<b>Assessor signature</b>	<i>A. Tutor</i>	<b>Date</b>	<i>17.05.10</i>
<b>Internal Verifier signature</b>	<i>A.N. Internal Verifier</i>	<b>Date</b>	<i>21.05.10</i>

# SAMPLE ACTION BASED ACTIVITY

## ESSENTIAL SKILLS COMMUNICATION LEVEL 2

<b>NAME:</b>	<i>A Student</i>
<b>VOCATIONAL COURSE:</b>	<i>Joinery On-site</i>
<b>E. SKILLS COMMUNICATION TUTOR -</b>	<i>A Tutor</i>
<b>TOPIC:</b>	<i>Sustainable Resources</i>
<b>PROJECT QUESTION:</b>	<i>How can we choose wood products without damaging the environment?</i>

Planning and Drafting a Piece of Writing  
Mind Map Exploring Ideas

Always mind map your ideas so that you will have enough to write about. Each point on the mindmap will give you a lot of information for each paragraph.

Mind Map

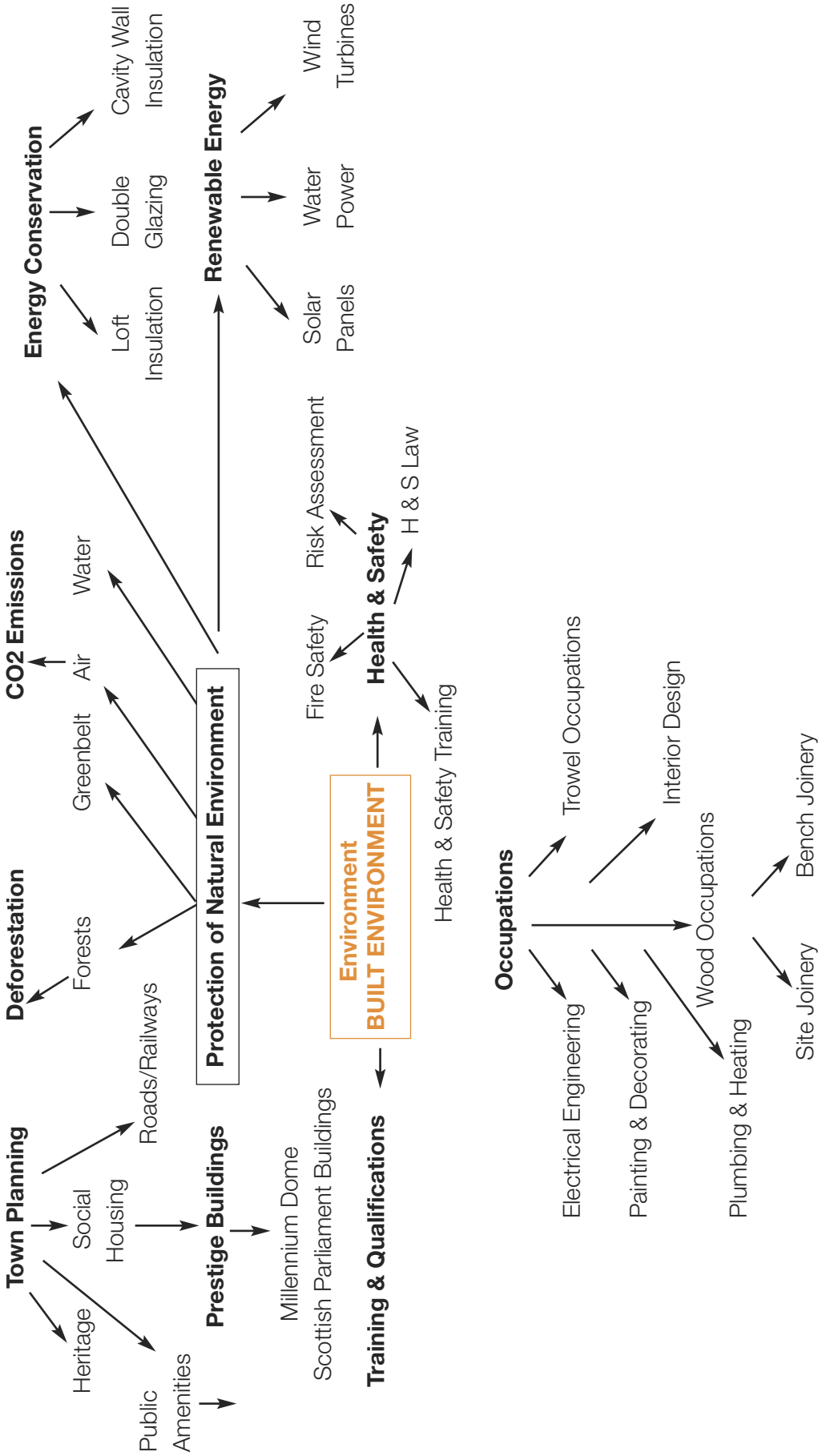

# SAMPLE ACTION BASED ACTIVITY

## NOTES FOR GROUP DISCUSSION

**Name:** A Student

**Topic:** Deforestation: how do we choose wood products without damaging the environment?

**Date:** 10th May 2010

### Issues:

- Deforestation is a global environmental problem.
- Developing countries most affected (e.g. South America, Southeast Asia and Africa.)
- Land, rivers, native people and animal and plant species are affected.
- Cut trees release tons of carbon dioxide into atmosphere adding to global warming
- We use wood for building, furniture and paper.

### What is being done?

- Groups such as the Forest Stewardship Council are working to cut out random logging.
- FSC operates all over the world to check that all logging is done in a way that will not harm the environment.
- It checks each step of wood distribution.
- An FSC label on wood tells you that the wood was harvested from sustainable forests.

### What more can we do?

- When choosing wood products for building or making furniture look for the FSC label.
- If there is no FSC logo, ask where the wood came from and if it was harvested sustainably.
- Natural Resources Defense Council (NRDC) wants buyers to avoid some tropical hardwoods if they do not come from sustainable forests.
- Avoid these types of trees that are hard to manage sustainably - Big Leaf Mahogany, Spanish Cedar, Caribbean Pine, Ipe, Rosewood, Teak, Ramin, Merbau, African Mahogany, and Okoume
- Above trees grow sparsely in forests and do not grow back again quickly.
- Be careful what you buy. Some woods products may have FSC-certified wood but not have a logo because they do not need to go through the certification procedure. If in doubt ask!
- It is better to use reclaimed or salvaged wood as these do no damage to any forests.
- They may be found in used building supply stores and construction sites.
- Think about using recycled plastic lumber or composites if they would suit your project.

### Questions I would like to ask the group

1. Are there lists of reputable dealers for builders to buy their materials from?
2. Would it be a good idea to increase the cost of tropical woods to help put a stop to marketing wood from unsustainable forests?
3. Should there be penalties for anyone using wood from endangered forests?

### Conclusion

The group agreed that instead of choosing woods that come from tropical rainforests that we should choose from the many types and varieties that would suit just as well and would not damage the environment. Buyers should check the labels on wood for building, furniture making and paper.

# SAMPLE ACTION BASED ACTIVITY

**Take part in a group discussion.**

**Topic:** How do we choose wood products without damaging the environment?

<b>Make clear and relevant contributions in a way that suits your purpose and situation.</b>	Student A researched and made notes on the topic for discussion. He made the point that choosing woods such as Maple, Oak, or Pine rather than Mahogany or Malaysian Hardwoods would ensure the market for these tropical forest trees would dry up.
<b>Respond appropriately to others.</b>	He developed Student B's point that making people aware of the problem would be a good place to start by suggesting children should be educated regarding these important issues.
<b>Help to move the discussion forward</b>	Student A played a full part in the discussion, introducing new points (web addresses to visit to learn about the sources of different woods) and asking questions, e.g. 'Does the group think that the EU should stop trading with companies that destructively clearcut tropical rainforests?'

**Signed Candidate:** A Student

**Date:** 17.05.10

**Signed Assessor:** A Tutor

**Date:** 17.05.10

# SAMPLE ACTION BASED ACTIVITY

**Assessor:** A Tutor**Candidate:** A Student**Date:** 17.05.10**Give a talk of at least four minutes.****Topic:** Deforestation and what we can do about it.

<b>Speak clearly in a way that suits your subject, purpose and situation</b>	Student A gave a professional presentation to an audience of peers. He projected his voice well so that everyone could hear and maintained good eye contact with his audience.
<b>Keep to the subject and structure your talk to help listeners follow what you are saying</b>	A. used power point slides to help structure his talk and to introduce each new section. He used subheadings and bullet points to highlight the main points to make it easier for his audience to follow.
<b>Use appropriate ways to support your main points</b>	A. used comparative 'before' and 'after' photographic images to illustrate the points raised in his talk i.e. the devastation caused to tropical rainforests by unchecked logging.

**Signed Candidate:** A Student**Date:** 17.05.10**Signed Assessor:** A Tutor**Date:** 17.05.10





# Deforestation

## (And what we can do about it!)

The Impact of the Built Environment on the Natural Environment

By A Student

# Introduction (The Issues)

- Rainforests are vital to our planet but they are disappearing at an disturbing rate.
- Rainforests supply 35% of the worlds oxygen.
- A quarter of our medicines and 70% of plants used to fight cancer are found only in rainforests.
- Ecosystems are disappearing -137 species of plants, animals and insects per day (50,000) species a year
- Every second, 1 ½ acres of tropical rainforest are lost to the world. This is a disaster for us all.

# Reasons for Deforestation

- Rainforests are cut down to make way for farmland to grow crops and bred livestock.
- Precious metals are also found in the tropics and trees are cut down for mining.
- Rivers are dammed for power and water supplies.
- Rainforest wood is sold as timber and is burned as fuel. Hardwoods from the tropics are in big demand in the developed world and are used to make furniture and in building timber framed houses.

This is a picture of a rainforest before  
the loggers came.



This is a picture of the after effects of  
Deforestation





# Before and After Pictures

- These before and after photographs show the devastation that deforestation causes.
- Picture 1 – In the ‘before’ picture you can see the lush green forests that is home to many species of plants and animals.
- Picture 2 – The ‘after’ picture shows that there is little hope of survival for any of those species once the forests have been cut down.

# Tropical timber

- Wood from tropical rainforests is popular in Europe and the United States.
- Mahogany and Malaysian Hardwoods come from the tropical rainforests.
- We use it for furniture, hardwood flooring, boats and ornaments.

# Harvesting Tropical Wood

- How the wood is harvested makes all the difference.
- Wood may be harvested using:
  1. **Selective logging** – where some of the trees are cut down and some are replaced.
  2. **'Clearcutting'** a forest is where all the trees are cut down.
- How was your wood harvested?



# How was your wood harvested?

- Selective Logging happens mainly in Central and South America and Africa. If done properly, selective logging limits the damage done to the forest and allows the forest to grow back fairly quickly.
- Forests are 'Clearcut' mainly in Southeast Asia where the wood is more valuable. More devastation happens through clearcutting.

# Reforestation



Here a scientist is growing a Mahogany seedling to plant back in the forests of South America where Mahogany is native and belongs

## Reforestation and Plantations

Some forests are reforested but it is important to do this properly.

Reforestation is only useful if the trees planted as a replacement are native to the area.

It is important that the trees that are replanted are a species from the area.

Replanting in Costa Rica is done with **Teak**, which is from India and is no benefit to the wildlife of Costa Rica.

# So is it always wrong to buy wood from tropical trees?

- No. But it is important to look at the labels of the wood you buy.
- If wood or wood products come from Malaysia, Thailand, China, Indonesia or any other Southeast Asian country, you can be fairly sure the wood came from clearcutting rainforests.
- Look for alternatives to Mahogany and Malaysian Hardwoods.
- Woods such as Maple, Oak, or Pine might do the job just as well.
- If you do not know the source of a wood product or how it was harvested – DO NOT BUY IT!

# Wood Products from North America, Europe and Northern Asia.

- Using Old Growth wood is not to be recommended.
- Old Growth forests are ancient forests that have not changed much over the centuries.
- They are our heritage and should be protected for future generations.

# Find Out More

- [SmartWood.org](https://SmartWood.org)

This site provides information on forestry practices that are protective of the environment.

- Rainforest Action Network looks at Alternatives to OldGrowth that are appropriate for the environment.

# How can we help?

- Wood from tropical rainforests is used for furniture, hardwood flooring, boats and ornaments
- It is important to look at the labels of the wood you buy.
- Look for alternatives to Mahogany and Malaysian Hardwoods.
- Woods such as Maple, Oak, or Pine would do just as well.
- If you do not know the source of a wood product or how it was harvested – DO NOT BUY IT!

# Conclusion

- Any questions or observations?

# SAMPLE ACTION BASED ACTIVITY

## DOCUMENT 1

### Which Wood Should We Buy?

**Support good forest management with your consumer choices.**

**5.1.2010**

#### EarthTalk The Environmental Magazine

Deforestation continues to be one of the world's biggest environmental problems, especially in fast developing regions like South America, Southeast Asia and Africa. Cutting down large numbers of trees erodes land and silts waterways, displaces native people and wildlife, and releases tons of carbon dioxide (which is stored in living wood fiber) into the atmosphere, contributing to global warming.

Of course, wood products are essential to modern life. Without wood we wouldn't have the buildings, furniture, paper and other essentials we make use of every day. That's why protecting sources of wood has become a leading concern among not just environmentalists but everyone else as well.

In response to the problems wrought by increasing deforestation, some forward-thinking wood products professionals teamed up with environmentalists, native people's advocates, community forestry groups and responsible corporations to form the nonprofit Forest Stewardship Council (FSC) in 1993. Previous attempts to stem the tide of unchecked logging—including international negotiations and boycotts—were having little effect, so FSC vowed to use the power of market forces to create change for the better.

FSC promotes responsible management of forests by certifying forestry operations around the globe and promoting its certification system at every step of the wood products distribution chain. Whether you're shopping for wooden furniture, building materials or other items, one easy way to tell if the wood you are considering buying was harvested from sustainable sources is to look for the FSC label on it or its packaging. If it is, you can trust that such products were harvested sustainably and are not contributing to deforestation-related woes. If you don't see the FSC logo, you should inquire as to where the wood came from and whether or not it was harvested sustainably.

The nonprofit Natural Resources Defense Council (NRDC) warns consumers to avoid purchasing some tropical hardwoods unless they can be assured that it came from sustainable forestry operations. Many of these woods—including Big Leaf Mahogany, Spanish Cedar, Caribbean Pine, Ipe, Rosewood, Teak, Ramin, Merbau, African Mahogany, and Okoume—are difficult to manage sustainably as they typically grow in low densities in natural forests and regenerate poorly after logging. Some woods and wood products may contain FSC-certified wood without bearing the logo, while other woods may be OK without going through the FSC certification process. If you don't see an FSC logo you should ask. If the store salesperson can't provide information, then you can't be sure.



# SAMPLE ACTION BASED ACTIVITY

Even better than purchasing sustainably harvested new wood is to seek out reclaimed or salvaged wood, as it precludes the need for logging altogether. An added benefit of using reclaimed or salvaged wood - look for it at used building supply stores and even at construction sites where older materials are being tossed - is that it provides incentives for municipal recycling programs. NRDC suggests that if you can't source used wood, consider recycled plastic lumber or composites if they are applicable for your project.

GOT AN ENVIRONMENTAL QUESTION? Send it to: EarthTalk, c/o E/The Environmental Magazine, P.O. Box 5098, Westport, CT 06881; submit it here or via e-mail. Read past columns here and check out the recent book Earthtalk: Expert Answers to Everyday Questions about the Environment

## 505 Words

### Main Points of Document 1

- By buying wood carefully you can support endangered forests.
- Globally, deforestation is a huge environmental problem especially in South America, Southeast Asia and Africa.
- Deforestation erodes land, blocks waterways and destroys human and wildlife habitats.
- Carbon dioxide is stored in living wood and tons of it is released into the atmosphere, adding to global warming, when forests are cut down.
- Wood is needed for buildings, furniture and paper so its source needs to be protected.
- The Forest Stewardship Council (FSC) was set up in 1993 to work towards bringing an end to unchecked logging.
- The FSC is made up from wood produce professions, environmentalists, native people's advocates, community forestry groups and corporations.
- FSC certifies each step of forestry operations at each step of the distribution chain.
- Wood products (furniture, building materials etc) that have been harvested sustainably will have an FSC label on it.
- If products do not have the FSC logo then ask where the wood came from.
- Natural Resources Defense Council (NRDC) urges purchasers not to buy some tropical hardwoods if cannot prove they came from sustainable forestry operations.
- Big Leaf Mahogany, Spanish Cedar, Caribbean Pine, Ipe, Rosewood, Teak, Ramin, Merbau, African Mahogany and Okoume grow fairly sparsely in natural forests and do not regenerate well once they have been cut down.
- The best wood products to buy are reclaimed or salvaged wood which can be found at used building supplies stores and construction sites.

**Source:** Earth Talk: The Environmental Magazine  
[www.thedailygreen.com/environmental-news/latest/sustainable-wood](http://www.thedailygreen.com/environmental-news/latest/sustainable-wood)

**Title:** 'Support good forest management with your consumer choices.'

**Authors:** By Editors of E/The Environmental Magazine

**Date:** 5.01.2010

# SAMPLE ACTION BASED ACTIVITY

## DOCUMENT 2

### Madagascar bans rainforest timber exports following global outcry

**Rhett A. Butler, wildmadagascar.org**  
**March 25, 2010**

Under mounting pressure over illegal logging of its national parks, Madagascar's transitional government on Wednesday reinstated a ban on rosewood logging and exports.

The decree (no. 2010-141), which prohibits all exports of rosewood and precious timber for two to five years, was announced during a council meeting held yesterday at Ambohitsorohitra Palace in Antananarivo, Madagascar's capital city. Madagascar's Minister of Environment has already proposed a plan to address the illegal timber trade, according to the Madagascar Tribune.

With the export ban in place, the fate of 10,000-15,000 metric tons of rosewood awaiting export remains uncertain. It is also unclear whether illegal loggers and traders will be prosecuted. Nevertheless, groups that have been protesting the resumption in exports of illegally logged timber cautiously welcomed the move.

**“The moratorium is a massive victory on the rosewood front,” said Derek Schuurman, a tour operator and author who has been a vocal opponent of rosewood trafficking. “Global outcry over rosewood logging obliged the government to take action.”**

**“There is still a lot to do... but we have succeeded on the first step,” added Lucienne Wilmé, a French scientist who has been tracking the rosewood trade.**



Criticism of rosewood trafficking ratcheted up in last week when Delmas, a French cargo company, resumed timber shipments from Vohemar, a port in northeastern Madagascar where large stockpiles of rosewood are held. Ecological Internet, a Web-based activist group, expanded an email campaign which has sent thousands of messages of protest, while environment groups Global Witness and the Environmental Investigation Agency (EIA) launched a public appeal to the governments of France and Madagascar. The concerns were spotlighted in national and international press, putting pressure on Madagascar's transition government, which sanctioned timber exports at the end of 2009 despite a long-standing ban on rosewood logging.

But questions remain on whether the current government — which seized power during a military coup a year ago — has the will to effectively implement and enforce the moratorium. Some prominent advisers to the administration have been linked to the timber trade.

# SAMPLE ACTION BASED ACTIVITY

Andrea Johnson of EIA, an NGO that has been documenting timber trafficking, told mongabay.com that it is too early to say whether the moratorium will effectively address Madagascar's illicit rosewood trade.

"We're hopeful that this moratorium marks a decision by the transition government to consider the long-term value of Madagascar's natural resources and end the uncontrolled exploitation of the forest for quick profit," she wrote via email. "We'd like to believe this is actually the beginning of a new book, not just the start of another chapter in the recent sad story of corruption and plunder of Madagascar's irreplaceable forests."

## Rosewood's toll

In the aftermath of a military coup last March, Madagascar's rainforests were pillaged for precious hardwoods, including rosewood and ebony. Tens of thousands of hectares were affected, including some of the island's most biologically diverse national parks: Marojejy, Masoala, and Makira. Illegal logging spurred the rise of a commercial bushmeat trade. Hunters slaughtered rare and gentle lemurs for restaurants. Timber trafficking, which involved armed gangs marauding through national parks, also hurt tourism, a critical source of direct and indirect income for many Malagasy, as the people of Madagascar are known. Rosewood traders intimidated, and in some cases, beat, those who attempted to stop the plunder.

**595 Words**

## Main Points of Document 2

- Madagascar has banned rainforest timber exports.
- The government has come under pressure from international environmental groups to put an end to illegal logging and exporting of rosewood trees from Madagascar's National Parks.
- Exports of rosewood and valuable timber are banned for two to five years.
- It is not known what will happen to the 10,000-15,000 metric tons of rosewood that is stockpiled in for exportation.
- It is not known if illegal loggers will be prosecuted.
- This is the first step in permanently stopping illegal logging in Madagascar.
- A French cargo company heightened the rosewood trafficking problem recently when it collected timber shipments from port Vohemar in Madagascar.
- An activist group, Ecological Internet, sent thousands of emails protesting against the French exporters and environment groups, Global Witness and the Environmental Investigation Agency, made an appeal to the French government. The actions of the cargo company were reported in the international and national newspapers.
- This action put pressure on Madagascar's government who turned a blind eye to timber exports even though there was a ban on rosewood logging.

**Source:** [www.wildmadagascar.org](http://www.wildmadagascar.org)

**Title:** 'Madagascar bans rainforest timber exports following global outcry.'

**Author:** Rhett A. Butler

**Date:** 25.03.10

# SAMPLE ACTION BASED ACTIVITY

## Save Our Trees or Pay the Price!

**By Martin James**

It is important to choose the wood you are buying very carefully as it may have come from endangered forests. All over the world, deforestation is a huge environmental problem and it is especially a problem in South America, Southeast Asia and Africa.

Deforestation erodes the land, blocks up waterways and destroys human and wildlife habitats. Carbon dioxide is stored in living wood and, when it is cut down, tons of it is released into the atmosphere. This adds to the problem of global warming.

In the modern world we need wood for buildings, furniture and paper, so its source needs to be protected if we are to have enough wood for future requirements.

Madagascar has banned rainforest timber exports but environmental groups know this is just the first step in permanently stopping illegal logging in Madagascar.

The government has come under pressure from international environmental groups to put an end to illegal logging and exporting of rosewood trees from Madagascar's National Parks. Exports of rosewood and valuable timber are banned for two to five years.

It is not known what will happen to the 10,000-15,000 metric tons of rosewood that is stockpiled in for exportation or if illegal loggers will be prosecuted because of the new laws.



The pressure to stop the illegal trafficking of rosewood heightened when a French cargo company collected timber shipments from port Vohemar in Madagascar. In protest, an activist group, Ecological Internet, sent thousands of emails objecting to the actions of the French exporters. They were backed by environment groups, Global Witness and the Environmental Investigation Agency, who appealed to the French government. The actions of the cargo company were reported in the international and national newspapers putting pressure on Madagascar's government who had previously turned a blind eye to timber exports even though there was a ban on rosewood logging.

In 1993 the Forest Stewardship Council (FSC) was set up to work towards bringing an end to unchecked logging. The FSC is made up from wood produce professionals, environmentalists, native people's advocates, community forestry groups and corporations. The FSC certifies each step of forestry operations in the distribution chain.

Wood products (furniture, building materials etc) that have been harvested sustainably will have an FSC label on it. If products do not have the FSC logo then it is important to ask where the wood came from.

The Natural Resources Defense Council (NRDC) also urges purchasers not to buy some tropical hardwoods if cannot prove they came from sustainable forestry operations. Big Leaf Mahogany,

# SAMPLE ACTION BASED ACTIVITY

Spanish Cedar, Caribbean Pine, Ipe, Rosewood, Teak, Ramin, Merbau, African Mahogany and Okoume grow fairly sparsely in natural forests and do not regenerate well once they have been cut down. Opt for bamboo, cane, mango and maple if you truly want to make a difference to the environment.

The very best wood products to buy are reclaimed or salvaged wood which can be found at used building supplies stores and construction sites.

Instead of buying wood for flooring, home owners can choose to use eco friendly rubber tiles, bamboo or cork flooring from [www.sustainablefloors.co.uk](http://www.sustainablefloors.co.uk). The options are there if we just take the time to look for them.

To anyone who thinks that deforestation is not a serious issue I would ask them to think about what will happen when the problem begins to affect our ability to have the wood we need for building, furniture or paper. Are we prepared to live in a world like that?

**530 Words**

# SAMPLE ACTION BASED ACTIVITY

39 Castle Street  
Lisburn  
Co Antrim  
BT27 4SU

Greenpeace  
Canonbury Villas  
London  
N1 2PN  
29th March 2010

Dear Greenpeace

I would like to apply to join your organisation as I am interested in knowing more about sourcing wood from sustainable sources for my building projects.

I am an apprentice site joiner and I plan one day to own my own business. I would like to start up my own salvage company and would appreciate your advice in how to go about this while guarding against receiving wood from endangered forests.

I would particularly like to become involved in the Sustainable Forestry Initiative which certifies wood for building as logged from sustainable forests.

I am also interested in the Global Forestry Services Inc 'Wood Tracking Programme' which monitors manufacturers and traders use of wood from its source to the finished product. I would like to know for sure if the wood I am using is from an accredited source.

I realise that this kind of work will be challenging and I would appreciate it if you would outline some of the details for me while I await full membership.

Yours sincerely

**A Student**

A Student





# References



### **Useful Websites and Books**

There are many useful books, articles and websites you can use to research documents for your Essential Skills Action-based Activity or just to practice your skills.

#### **[www.cityandguilds.com](http://www.cityandguilds.com)**

For Action based Activity ideas in construction.

Joinery- on site

Joinery – bench

Tiling

Brickwork

Plumbing

Construction – Health and Safety

Painting and Decorating

#### **[www.bbc.co.uk/skillswise](http://www.bbc.co.uk/skillswise)**

This website has a wealth of information on all aspects of communication for Level 2 Communication students. There are fact sheets at different levels which explain things clearly and worksheets that allow you to work on reading, writing, spelling, grammar, vocabulary and listening skills. There are sports and news quizzes and cool interactive games. Have fun!

#### **[www.visuword.org](http://www.visuword.org)**

Is an online dictionary, thesaurus.

#### **[www.freerice.org](http://www.freerice.org)**

To help you learn new words – and also send food to Africa. It's a win-win situation!

#### **[www.gcsebitesize.org](http://www.gcsebitesize.org)**

Is a website for GCSE students and will provide help for students working at Level 2.

#### **[www.skillsworkshop.org](http://www.skillsworkshop.org)**

Provides Essential Skills Literacy and Numeracy resources to L2

#### **[www.teachit.ac.uk](http://www.teachit.ac.uk)**

### **Your Own Work and NVQ Construction Tutors' Handouts**

You can do your Action-Based Activity (project) on your job or the construction course you are doing at the moment. The articles that your construction tutor gives you may provide you with documents that can be used in your Essential Skills Action-based Activity.

Health and Safety at Work

**[www.safetyline.wa.gov.au](http://www.safetyline.wa.gov.au)**

**[www.bbc.co.uk/health/health\\_living/health\\_at\\_work](http://www.bbc.co.uk/health/health_living/health_at_work)**

#### **[www.hse.gov.uk/construction/experience.htm#ladders](http://www.hse.gov.uk/construction/experience.htm#ladders)**

Pictures highlighting problems with how ladders are being used and how things could be put right.

#### **[www.hse.gov.uk/construction/information.htm](http://www.hse.gov.uk/construction/information.htm)**

Free downloadable information for the construction industry. It covers such areas as health and safety, risk assessment and workplace transport. You will find more links to PDF guides.



**[www.hse.gov.uk/construction/clients.pdf](http://www.hse.gov.uk/construction/clients.pdf)**

Guidelines for clients on construction sites and what they need to be aware of.

Construction

**[www.citbcsni.org.uk](http://www.citbcsni.org.uk)**

This is CITB-ConstructionSkills Northern Ireland website containing information on qualifying the workforce, improving business and recruiting new entrants.

**[www.bconstructive.co.uk](http://www.bconstructive.co.uk)**

List of careers and job profiles of occupations within the construction industry.

**[www.considerateconstructors/bbc/learningzone](http://www.considerateconstructors/bbc/learningzone)**

**[www.trada.co.uk](http://www.trada.co.uk)**

The Timber Research and Development Association is an internationally recognised centre of excellence for timber and wood products.

**[www.bre.co.uk](http://www.bre.co.uk)**

The Building Research Establishment (BRE) carries out research and testing for construction and the built environment in the UK. They look at building codes and Building Regulations

**[www.wmsa.org.uk](http://www.wmsa.org.uk)**

Suppliers of woodworking machinery.

**[www.goodbuilderguide.co.uk](http://www.goodbuilderguide.co.uk)**

This website shows you how to find a builder you can trust.

**[www.findalocalbuilder.com](http://www.findalocalbuilder.com)**

How to go about finding builders in the local area.

**[www.constructionalliance.org](http://www.constructionalliance.org)**

Construction recruitment agency supplying permanent and temporary construction workers and staff for the UK construction industry.

**[www.selfbuild123.co.uk/construction](http://www.selfbuild123.co.uk/construction)**

Information for selfbuilders.

**[www.homebuilding.co.uk](http://www.homebuilding.co.uk)**

Masonry VS Timber builds.

Videos

Construction v Timber You

**[www.youtube.com](http://www.youtube.com)** - Videos

Construction versus Timber

**[www.completehome.ie/page/tips/39/](http://www.completehome.ie/page/tips/39/)**

Decide if it is better to move or improve.

## **Health and Safety Resources**

**[www.safetyline.wa.gov.au/PageBin/actsoha0015](http://www.safetyline.wa.gov.au/PageBin/actsoha0015)**

**<http://www.hse.ie/publisher/index.jsp?&1nID=102&nID=111&aID=713>**

**[www.bbc.co.uk/health/healthy\\_living/health\\_at\\_work](http://www.bbc.co.uk/health/healthy_living/health_at_work)**

Useful resource for any work-related health issue, including physical health, emotional well being, balancing work and family, practical considerations and working abroad. Also a list of links and organisations.

## **Books**

Brett,P (2002)(2nd Edition) A Building Craft Foundation -  
Construction NVQ Series Levels 1 & 2 Nelson Thornes

Brett,P (2002) (2nd Edition) Site Carpentry and Joinery Construction NVQ Series Levels 1& 2 Nelson  
Thornes

Brett,P (2002) (2nd Edition) Bench Joinery - Construction NVQ Series Levels 1 & 2- Nelson Thornes

Brett,P (2002) (2nd Edition) Wood Occupations - Construction NVQ Series Level 1 - Nelson Thornes

The Guide to Workplace Health and Safety Health and safety Executive for Northern Ireland (also  
online) 83 Ladas Drive, Belfast BT6 9FR, Northern Ireland Tel: 028 9024 3249